

**HY Series Pneumatic Actuator**  
**HY系列气动执行器**



**无锡芮斯邦流体控制**  
**Wuxi Respon Flow Control**



## Content 目录

Products Show 产品展示	03	Output Torque of Double Acting Actuator 双作用输出扭矩	11
Structural Features 结构特点	05	Output Torque of HY-B Spring Return Actuator (FC) HY-B系列气动执行器单作用输出扭矩 (FC)	13
Performance Characteristics 性能特点	07	Output Torque of HY-B Spring Return Actuator (FO) HY-B系列气动执行器单作用输出扭矩 (FO)	15
Parts and Materials 零件与材料	09	Output Torque of HY-C Spring Return Actuator (FC) HY-C系列气动执行器单作用输出扭矩 (FC)	17



Output Torque of HY -C Spring Return Actuator (FO)  
HY -C系列气动执行器单作用输出扭矩 (FO)

19

Dimension of HY -C Spring Return Actuator (FC)  
HY -C单作用执行器外形尺寸 (FC)

25

Sizing 选型

20

Dimension of HY -C Spring Return Actuator (FO)  
HY -C单作用执行器外形尺寸 (FO)

27

Dimension of HY -B(C) Double Acting Actuator  
HY -B(C)双作用执行器外形尺寸

21

Modular Design 模块化设计

29

Dimension of HY -B Spring Return Actuator [FC(O)]  
HY -B单作用执行器外形尺寸 [FC(O)]

23

Body connecting dimension / How to order  
箱体连接尺寸及订购信息

30

**Products Show**  
**产品展示**



**打造全球执行器及阀门附件专业供应商**

*The Global Provider of Actuators*



互赢 互利 共存  
*Mutually Beneficial Relationships*



专注 专业 卓越  
*Focus On Professionalism*

成为您的最佳合作伙伴  
*To Be Your Best Partner*

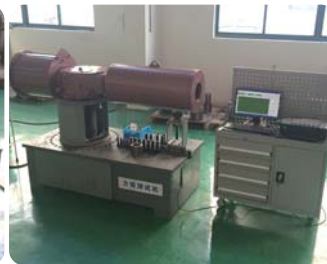

二十年的行业经验 一站式的产品和服务

*Twenty years experience "one-stop" goods and services*



## Structural Features

### 结构特点

#### Design and Construction

##### 设计和结构

HY series pneumatic and hydraulic actuators provide global customers with the latest in valve actuation design. It is a highly unique and reliable means of operating ball, butterfly or plug valves along with 90 degree rotating mechanisms.

HY系列执行器采用最新的设计方案，是球阀，蝶阀，旋塞阀和其他90度旋转机械装置安全的驱动方法。

#### Robust Yet Lightweight Design

##### 高强度，精小型设计

Totally enclosed weatherproof centrebody fabricated in carbon steel or ductile iron provide an excellent strength to weight ratio.

The mechanism of piston and yoke has an advantage torque output.

全天候防护性中心箱体模块采用碳钢或者球铁材质，确保了足够的强度。

活塞式及传动拨叉式提供了最佳的扭矩输出特性。

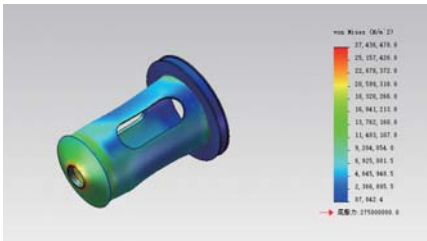
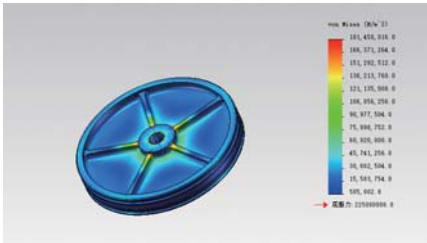
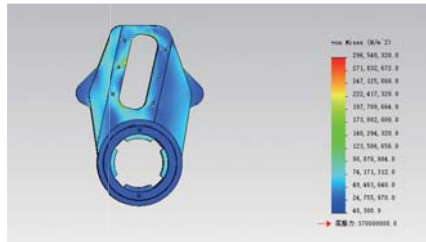

#### Modular Design

##### 模块化设计

HY series actuators share a modular construction design. The centre body is available in six sizes. A pneumatic or hydraulic cylinder can be attached to either or both sides. A spring cartridge can also be fitted to either side for ESD (emergency shut down) applications. Modular construction and stocking of components by facilitates quick delivery times.

HY系列执行器采用了模块化设计。中间箱体有6个规格，气缸或者液压缸可以单面安装也可以双面安装。需要紧急切断的工况，可以在箱体一侧安装一个弹簧复位模块。模块化设计的部件具有可替换，可仓储等特性，可以满足较短的供货周期。

## Manual Override Options

### 手动功能

独立的侧向手动装置是阀门或者执行器非常重要的一个部件。手动方式有丝杠、齿轮、离合式齿轮，液压手动等方案。

A dependable manual override facility is an important part many valve/actuator applications.

Available options include open or enclosed screws in both gear reducer and, declutch override gear box, as well as a number of hydraulic override solutions.



## Extensive Product Range

### 产品拓展

We provide the most extensive line of fluid power valve actuators. Products include low and high pressure pneumatic, hydraulic and pneumatic-hydraulic actuators.

我们可以提供多种驱动方式的阀门执行器，包括低气压，高气压气动、液动和气液联动等。

## Minimum Maintenance

### 免维护工作

Every HY actuator is built to provide long and efficient service with minimum maintenance. The design, engineering and materials used in their construction ensure optimum performance even in the harshest of environments.

每一个HY执行器都可以在免维护情况下提供长期高效的工作。

## Complete Control Solutions

### 各种控制方案

Air Control component packages are a part of any actuator/valve installation.

We have extensive experience in the design and assembly of all types of air control systems to satisfy any customer requirement for on/off, control or ESD service. Packages can be mounted on a panel or in a cabinet and mounted either on the actuator or at a remote location.

气动控制系统是任何阀门和执行器的一个重要组成部分。我们在气路控制方面具有丰富的经验，满足客户有关开关、调节和紧急切断等各方面的要求。气路系统可以安装在一个面板或者控制箱内，可以安装在执行器上或者单独放置。

## Performance Characteristics

### 性能特点

☞ The pinion full conform to the latest standards of ISO5211, NAMUR. The dimensions can be customized and the stainless steel is available.

Position indicator with NAMUR is convenient for mounting accessories such as Limit Switch box, Positioner and so on.



The different materials rubber and PFA encapsulated O-rings can be used in a wider range of temperature and condition.

The double O-ring and bearing design ensure the stability and dependability of the cylinder modular.

各种材质橡胶密封圈及PFA包覆密封圈满足各种工况使用。双O形密封圈及导向环设计，确保气缸模块的稳定性及可靠性。

☞ Operating Ranges HY actuators have torque outputs for spring-return models in excess of 110,000 Nm and double-acting models in excess of 240,000 Nm.

Operating pressures are: 3~10Bar

HY单作用执行器可以提供超过110,000Nm，双作用可以提供超过300,000Nm的力矩输出。

工作压力: 3~10巴

☞ Operating temperatures standard -20°C to +80°C.

Optional trims include:

High Temperature -15°C to +150°C

Low Temperature -40°C to +80°C

工作温度:

标准 -20°C ~ +80°C

高温 -15°C to +150°C

低温 -40°C to +80°C

输出轴同时符合NAMUR、ISO5211标准。也可按客户要求的尺寸定制。

NAMUR 标准指示器便于安装位置开关、定位器等附件。

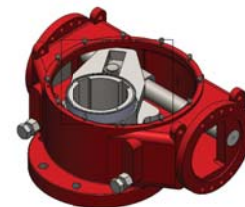
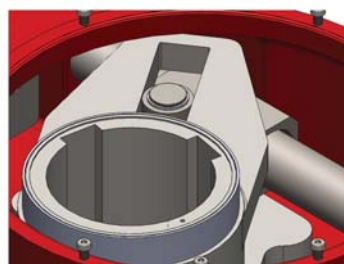
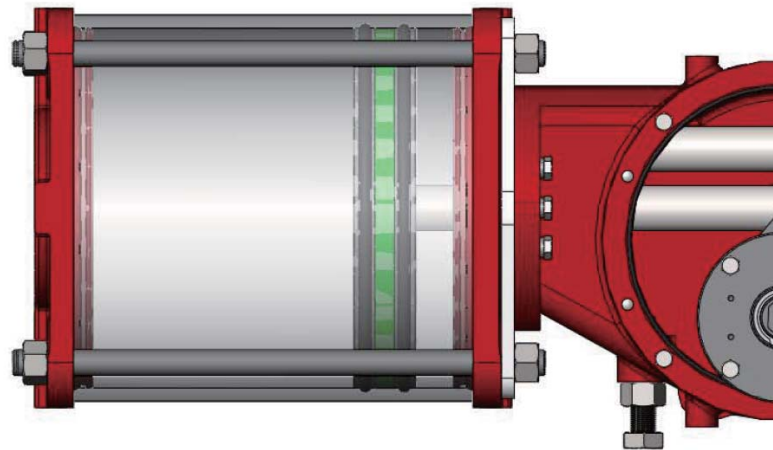



☞ Made from low friction, long-life compound material, to avoid the direct contact between metals. The maintenance and replacement are easy and convenient.

采用低摩擦、长寿命复合材料，避免了金属与金属的直接接触，维修更换简单方便。

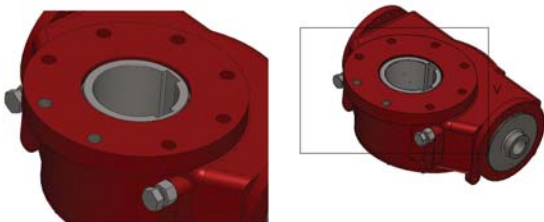

The Mounting Flange is up to the ISO 5211.  
底部与阀门连接法兰的尺寸符合ISO 5211标准。

☞ HY actuators are available with either B or C body modules. The B body modules provide efficient operation at both the break and end positions. The C body modules have a torque advantage in applications where higher break torque is needed to unseat the valve, with less critical needs at the run or full open positions.

HY执行器可以提供B和C两种传动箱模块。B传动箱能够提供起点和终点相同的输出力矩，更符合类似球阀的力矩需求。C传动箱能够提供更大的起始输出扭矩，更符合类似蝶阀的力矩需求。

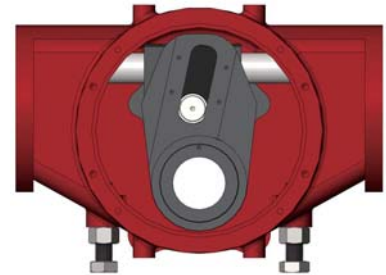
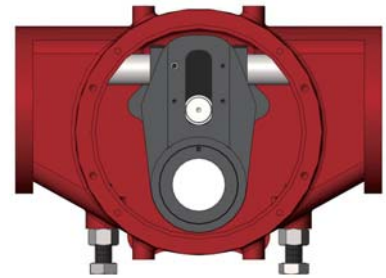
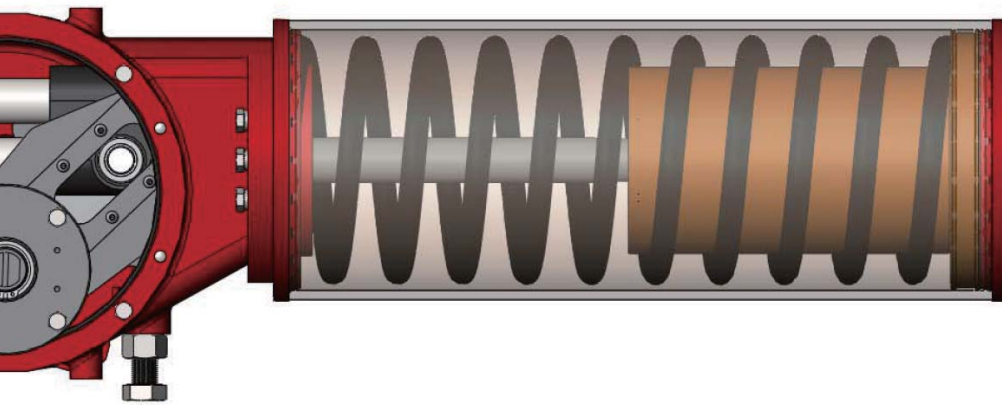

☞ Integral bi-directional travel stops, adjustable from  $-6^\circ$  to  $96^\circ$  of total valve travel, assist the HY Series in prolonging valve seat integrity.

两个独立的行程调节螺钉可以进行方便、精确  $\pm 6^\circ$  的调节开、关位置。

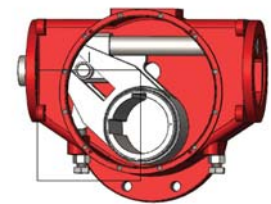
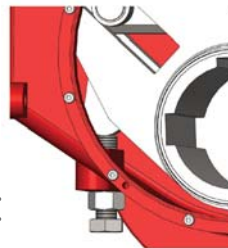
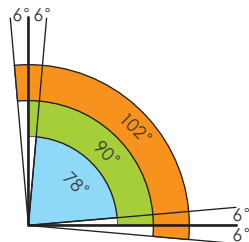

## Parts and Materials

### 零件与材料

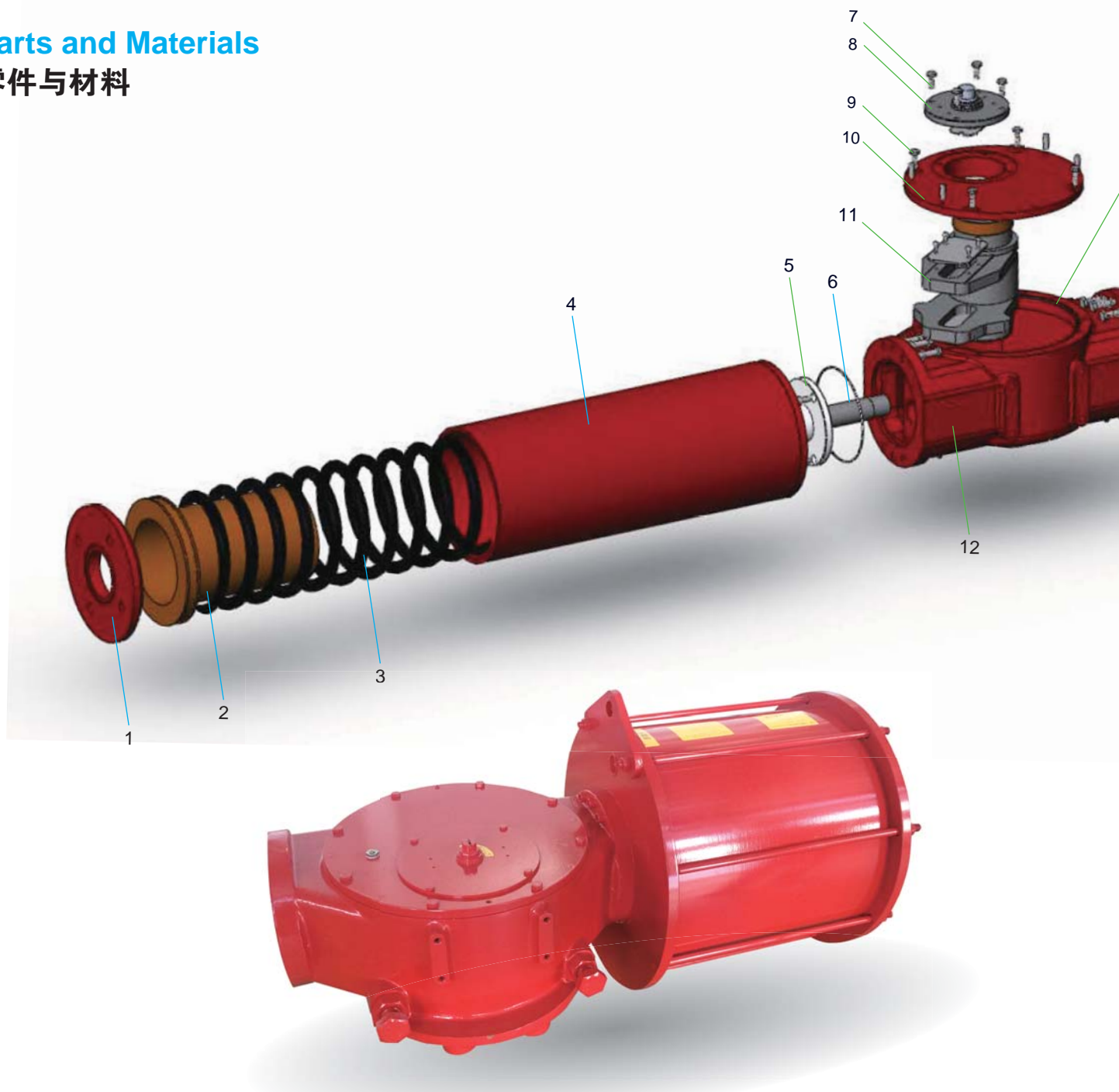

弹簧筒模块 Spring Modular

项目号	零件号 Name	数量 Qty.	材料 Materials
1	弹簧筒盖 Flange Cap	1	碳钢 Carbon Steel
2	弹簧座 Spring Seat	1	碳钢 Carbon Steel
3	弹簧 Spring	1	弹簧钢 Spring Steel
4	弹簧筒 Spring Body	1	碳钢 Carbon Steel
6	弹簧拉杆 Spring Stem	1	合金钢 Alloy Steel

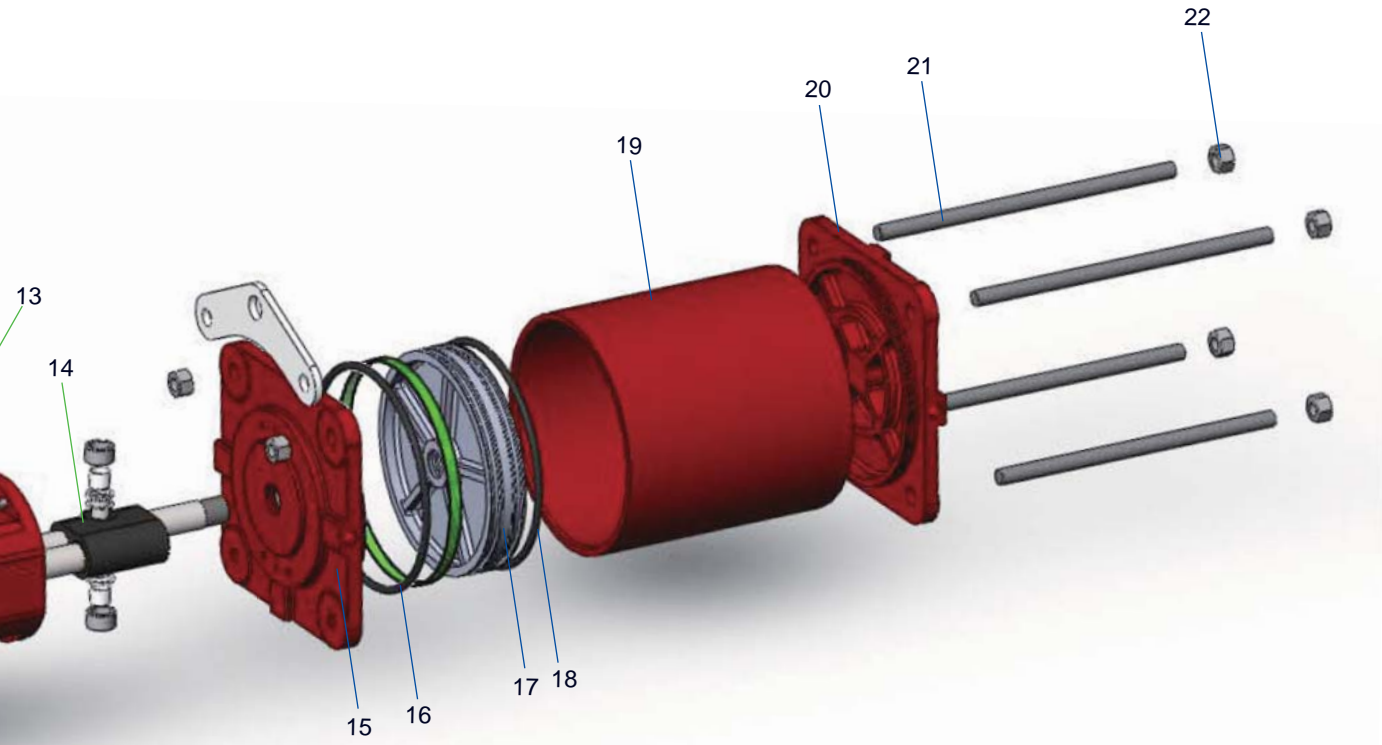

箱体模块 Centre Body Modular

项目号	零件号 Name	数量 Qty.	材料 Materials
5	衬套座 Bear Seat	1	碳钢 Carbon Steel
7	螺钉 Screw	n	碳钢 Carbon Steel
8	顶盖组件 Indicator	1	碳钢 Carbon Steel
9	螺钉 Screw	n	碳钢 Carbon Steel
10	箱盖 Centre Body Cap	1	球墨铸铁 Ductile Iron
11	拨叉 Yoke	1	球墨铸铁 Ductile Iron
12	箱体 Centre Body	1	球墨铸铁 Ductile Iron
13	箱盖密封圈 Cap O-ring	1	耐油橡胶 Rubber
14	导向传动组件 Drive Mechanism	1	合金钢 Alloy Steel

气缸模块 Cylinder Modular

项目号	零件号 Name	数量 Qty.	材料 Materials
15	气缸底座 Cylinder Seat	1	球墨铸铁 Ductile Iron
16	活塞O形圈 O Ring	1	耐油橡胶 Rubber
17	活塞 Piston	1	碳钢 Carbon Steel
18	导向环 Guide Ring	1	合成树脂 Resin
19	缸体 Cylinder Body	1	碳钢 Carbon Steel
20	缸盖 Cylinder Cap	1	球墨铸铁 Ductile Iron
21	螺钉 Screw	n	碳钢 Carbon Steel
22	螺母 Screw Nut	n	碳钢 Carbon Steel

Output Torque of  
 HY-B Series Double Acting Actuator  
 HY-B系列气动执行器  
 双作用输出扭矩

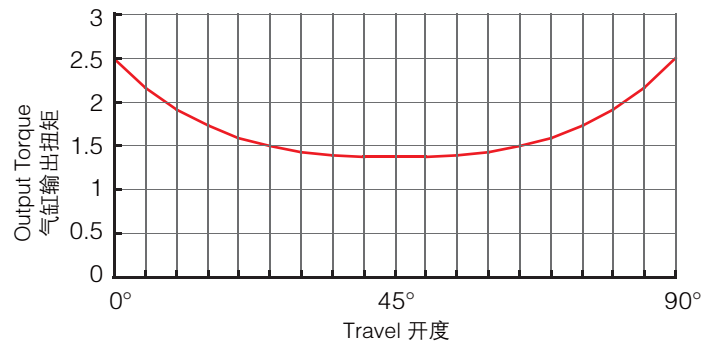

Model 型号	Output Torque 输出扭矩 (Nm) Air Pressure 气压 (Mpa)											
	0.35			0.4			0.5			0.6		
	0°	45°	90°	0°	45°	90°	0°	45°	90°	0°	45°	90°
HY-B06-201-DA	1269	670	1269	1451	766	1451	1814	958	1814	2154	1138	2154
HY-B08-221-DA	2000	1056	2000	2286	1207	2286	2857	1509	2857	3428	1810	3428
HY-B08-251-DA	2599	1372	2599	2970	1568	2970	3712	1960	3712	4455	2352	4455
HY-B1-281-DA	3836	2026	3836	4384	2315	4384	5480	2894	5480	6576	3473	6576
HY-B1-321-DA	5035	2659	5035	5754	3039	5754	7193	3798	7193	8631	4558	8631
HY-B1-351-DA	6039	3189	6039	6902	3644	6902	8627	4556	8627			
HY-B2-351-DA	7193	3798	7193	8220	4341	8220	10275	5426	10275	12330	6511	12330
HY-B2-401-DA	9440	4985	9440	10789	5697	10789	13486	7122	13486	16184	8546	16184
HY-B2-451-DA	11988	6330	11988	13700	7235	13700	17126	9043	17126			
HY-B3-451-DA	14306	7555	14306	16350	8634	16350	20438	10792	20438	24525	12951	24525
HY-B3-501-DA	17723	9359	17723	20255	10696	20255	25318	13369	25318	30382	16043	30382
HY-B3-561-DA	22297	11774	22297	25483	13456	25483	31854	16820	31854	38224	20184	38224
HY-B3-601-DA	25635	13537	25635	29297	15470	29297	36621	19338	36621			
HY-B4-601-DA	30797	16263	30797	35197	18586	35197	43996	23232	43996	52796	27879	52796
HY-B4-631-DA	33986	17946	33986	38841	20510	38841	48552	25638	48552	58262	30765	58262
HY-B4-502-DA	42584	22487	42584	48668	25699	48668	60835	32124	60835			
HY-B4-701-DA	42031	22195	42031	48036	25365	48036	60044	31707	60044			
HY-B4-562-DA	53576	28291	53576	61230	32332	61230						
HY-B4-801-DA	54993	29039	54993	62849	33188	62849						
HY-B5-701-DA	50399	26614	50399	57599	30416	57599	71999	38019	71999	86399	45623	86399
HY-B5-562-DA	64145	33872	64145	73308	38711	73308	91635	48388	91635	109963	58066	109963
HY-B5-801-DA	65984	34843	65984	75410	39820	75410	94263	49776	94263	113115	59731	113115
HY-B5-602-DA	73786	38963	73786	84327	44529	84327	105409	55661	105409	126491	66794	126491
HY-B5-632-DA	81454	43012	81454	93090	49156	93090	116362	61446	116362			
HY-B5-901-DA	83646	44169	83646	95595	50479	95595	119494	63099	119494			
HY-B5-702-DA	100799	53227	100799	115199	60831	115199						
HY-B5-1001-DA	103386	54593	103386	118155	62392	118155						
HY-B6-901-DA	112390	59348	112390	128446	67826	128446	160558	84783	160558	192669	101740	192669
HY-B6-702-DA	135271	71430	135271	154596	81635	154596	193245	102043	193245	231894	122452	231894
HY-B6-1001-DA	138964	73380	138964	158816	83863	158816	198519	104829	198519	238223	125795	238223
HY-B6-802-DA	177229	93586	177229	202547	106956	202547	253184	133695	253184			
HY-B6-902-DA	224781	118696	224781	256893	135653	256893						

Output Torque of  
HY-C Series Double Acting Actuator  
HY-C系列气动执行器  
双作用输出扭矩

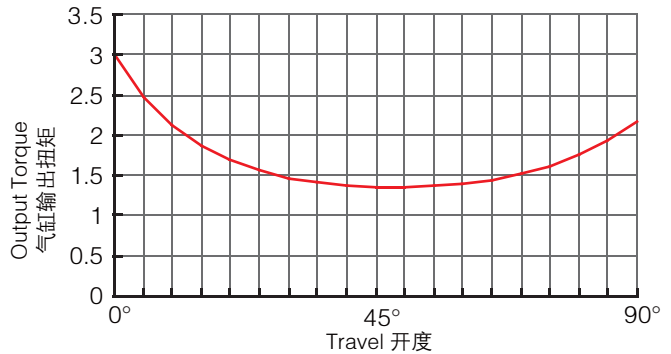

Model 型号	Output Torque 输出扭矩 (Nm)						Air Pressure 气压 (Mpa)					
	0.35			0.4			0.5			0.6		
	0°	45°	90°	0°	45°	90°	0°	45°	90°	0°	45°	90°
HY-C06-201-DA	1523	663	1068	1741	758	1220	2176	948	1525			
HY-C08-221-DA	2400	1045	1682	2743	1194	1922	3428	1493	2403	4114	1792	2883
HY-C08-251-DA	3118	1358	2185	3564	1552	2498	4455	1940	3122			
HY-C1-281-DA	4603	2005	3226	5261	2291	3687	6576	2864	4609	7891	3436	5531
HY-C1-321-DA	6042	2631	4234	6905	3007	4839	8631	3759	6049			
HY-C2-351-DA	8631	3759	6049	9864	4296	6913	12330	5369	8642	14796	6443	10370
HY-C2-401-DA	11329	4933	7939	12947	5638	9074	16184	7047	11342	19420	8457	13610
HY-C2-451-DA	14385	6264	10082	16441	7159	11522						
HY-C3-451-DA	17168	7476	12032	19620	8544	13750	24525	10680	17188	29430	12816	20626
HY-C3-501-DA	21267	9261	14905	24306	10584	17034	30382	13230	21293			
HY-C3-561-DA	26757	11652	18752	30579	13316	21431						
HY-C4-561-DA	32146	13998	22529	36738	15998	25747	45922	19997	32184	55107	23997	38621
HY-C4-601-DA	36957	16093	25901	42237	18392	29601	52796	22990	37001	63355	27589	44401
HY-C4-631-DA	40783	17760	28582	46610	20297	32666	58262	25371	40832			
HY-C4-701-DA	50437	21963	35348	57643	25101	40398						
HY-C5-701-DA	60479	26336	42386	69119	30099	48441	86399	37623	60551	103679	45148	72662
HY-C5-562-DA	76974	33519	53946	87970	38307	61652	109963	47884	77065	131955	57461	92478
HY-C5-801-DA	79181	34480	55492	90492	39406	63420	113115	49257	79275	135738	59109	95130
HY-C5-602-DA	88544	38557	62054	101193	44065	70919	126491	55082	88649			
HY-C5-632-DA	97744	42564	68503	111708	48644	78289						
HY-C5-901-DA	100375	43709	70346	114714	49954	80396						
HY-C6-801-DA	106337	46306	74525	121528	52921	85171	151911	66151	106464	182293	79381	127757
HY-C6-901-DA	134869	58730	94520	154136	67120	108023	192669	83900	135029	231203	100680	162035
HY-C6-702-DA	162326	70686	113763	185515	80784	130015	231894	100981	162519			
HY-C6-1001-DA	166756	72616	116868	190579	82989	133564	238223	103737	166955			
HY-C6-802-DA	212675	92611	149050	243057	105842	170342						

## Output Torque of HY -B Series Actuator with Spring Return (FC)

### HY -B系列气动执行器单作用输出扭矩 (FC)

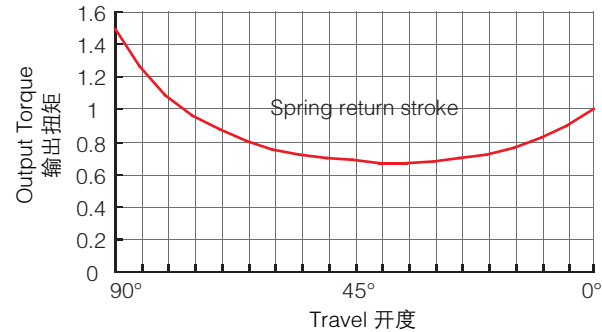
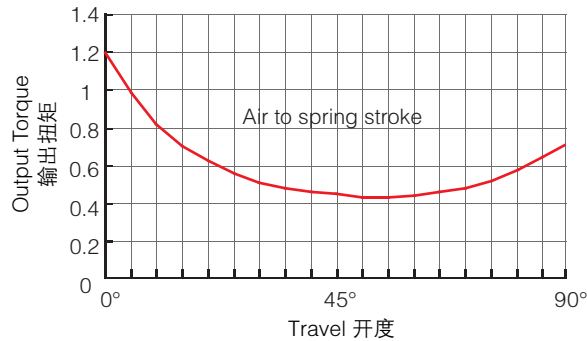

Model	Air to Spring (4Bar)			Spring			Air to Spring (5Bar)			Spring			Air to Spring (6Bar)			Spring		
	0°	45°	90°	90°	45°	0°	0°	45°	90°	90°	45°	0°	0°	45°	90°	90°	45°	0°
HY-B06-201-SRC4	934	383	549	902	383	517	1296	575	911	902	383	517	1659	766	1274	902	383	517
HY-B06-201-SRC5							1167	479	686	1128	479	646	1530	670	1049	1128	479	646
HY-B06-201-SRC6													1391	567	806	1370	582	785
HY-B06-221-SRC4	1116	452	635	1128	479	646	1557	685	1076	1128	479	646	1997	917	1516	1128	479	646
HY-B06-221-SRC5							1418	582	833	1370	582	785	1858	814	1274	1370	582	785
HY-B06-221-SRC6													1701	698	1000	1644	698	942
HY-B08-221-SRC4	1449	587	834	1452	620	837	2020	889	1405	1452	620	837	2591	1190	1976	1452	620	837
HY-B08-221-SRC5							1830	748	1075	1782	761	1027	2401	1049	1646	1782	761	1027
HY-B08-221-SRC6													2132	850	1180	2248	960	1296
HY-B08-251-SRC4	1943	807	1188	1782	761	1027	2685	1199	1930	1782	761	1027	3428	1591	2673	1782	761	1027
HY-B08-251-SRC5							2416	1000	1464	2248	960	1296	3159	1392	2207	2248	960	1296
HY-B08-251-SRC6													2828	1147	1633	2822	1205	1627
HY-B08-281-SRC4	2445	1016	1493	2248	960	1296	3381	1509	2429	2248	960	1296	4316	2003	3364	2248	960	1296
HY-B08-281-SRC5							3050	1264	1855	2822	1205	1627	3985	1758	2790	2822	1205	1627
HY-B08-281-SRC6													3612	1481	2142	3470	1482	2000
HY-B1-281-SRC4	2821	1157	1670	2714	1158	1563	3917	1736	2766	2714	1158	1563	5013	2315	3862	2714	1158	1563
HY-B1-281-SRC5							3478	1411	2004	3476	1483	2002	4574	1990	3100	3476	1483	2002
HY-B1-281-SRC6													4116	1651	2305	4271	1822	2460
HY-B1-321-SRC4	3752	1556	2278	3476	1483	2002	5191	2315	3717	3476	1483	2002	6629	3075	5155	3476	1483	2002
HY-B1-321-SRC5							4733	1976	2922	4271	1822	2460	6171	2736	4360	4271	1822	2460
HY-B1-321-SRC6													5408	2171	3034	5597	2387	3223
HY-B1-351-SRC4	4442	1822	2631	4271	1822	2460	6167	2734	4356	4271	1822	2460	7892	3645	6081	4271	1822	2460
HY-B1-351-SRC5							5404	2169	3030	5597	2387	3223	7129	3080	4755	5597	2387	3223
HY-B1-351-SRC6													6323	2483	3356	6996	2984	4029
HY-B1-401-SRC4	5819	2388	3445	5597	2387	3223	8080	3582	5706	5597	2387	3223	10340	4775	7966	5597	2387	3223
HY-B1-401-SRC5							7274	2985	4307	6996	2984	4029	9534	4178	6567	6996	2984	4029
HY-B1-401-SRC6													8729	3581	5168	8395	3581	4834
HY-B2-401-SRC4	6943	2848	4110	6679	2849	3846	9640	4273	6807	6679	2849	3846	12338	5697	9505	6679	2849	3846
HY-B2-401-SRC5							8603	3505	5005	8481	3617	4883	11301	4929	7703	8481	3617	4883
HY-B2-401-SRC6													10080	4024	5582	10602	4522	6104

Model	Air to Spring (4Bar)			Spring			Air to Spring (5Bar)			Spring			Air to Spring (6Bar)			Spring		
	0°	45°	90°	90°	45°	0°	0°	45°	90°	90°	45°	0°	0°	45°	90°	90°	45°	0°
HY-B2-451-SRC4	8817	3618	5219	8481	3617	4883	12243	5426	8645	8481	3617	4883	15668	7235	12070	8481	3617	4883
HY-B2-451-SRC5							11022	4521	6524	10602	4522	6104	14447	6330	9949	10602	4522	6104
HY-B2-451-SRC6													13226	5426	7829	12722	5426	7325
HY-B3-451-SRC4	10522	4317	6232	10118	4317	5828	14610	6475	10320	10118	4317	5828	18697	8634	14407	10118	4317	5828
HY-B3-451-SRC5							13186	5420	7847	12591	5372	7252	17273	7579	11934	12591	5372	7252
HY-B3-451-SRC6													15500	6266	8857	15668	6685	9025
HY-B3-501-SRC4	13003	5324	7664	12591	5372	7252	18066	7997	12727	12591	5372	7252	23130	10671	17791	12591	5372	7252
HY-B3-501-SRC5							16293	6684	9650	15668	6685	9025	21357	9358	14714	15668	6685	9025
HY-B3-501-SRC6													19028	7633	10671	19711	8410	11354
HY-B3-561-SRC4	16458	6771	9815	15668	6685	9025	22829	10135	16186	15668	6685	9025	29199	13499	22556	15668	6685	9025
HY-B3-561-SRC5							20500	8410	12143	19711	8410	11354	26870	11774	18513	19711	8410	11354
HY-B3-561-SRC6													24600	10092	14570	23654	10092	13624
HY-B3-631-SRC4	20977	8662	12619	19711	8410	11354	29059	12930	20702	19711	8410	11354	37142	17198	28784	19711	8410	11354
HY-B3-631-SRC5							26788	11248	16759	23654	10092	13624	34871	15516	24842	23654	10092	13624
HY-B3-631-SRC6													31210	12804	18486	30010	12804	17286
HY-B4-631-SRC4	24997	10255	14784	24057	10255	13844	34708	15383	24495	24057	10255	13844	44418	20510	34205	24057	10255	13844
HY-B4-631-SRC5							31246	12819	18481	30071	12819	17306	40956	17946	28191	30071	12819	17306
HY-B4-631-SRC6													35860	14171	19335	38927	16594	22402
HY-B4-701-SRC4	30730	12546	17964	30071	12819	17306	42739	18888	29973	30071	12819	17306	54748	25229	41982	30071	12819	17306
HY-B4-701-SRC5							37643	15113	21118	38927	16594	22402	49651	21454	33126	38927	16594	22402
HY-B4-701-SRC6													44052	17306	23396	48657	20742	28002
HY-B4-801-SRC4	40447	16594	23922	38927	16594	22402	56160	24891	39635	38927	16594	22402	71872	33188	55347	38927	16594	22402
HY-B4-801-SRC5							50560	20743	29904	48657	20742	28002	66272	29040	45616	48657	20742	28002
HY-B4-801-SRC6													60671	24891	35884	58390	24891	33603
HY-B5-801-SRC4	48531	19910	28703	46707	19910	26879	67384	29865	47556	46707	19910	26879	86236	39820	66408	46707	19910	26879
HY-B5-801-SRC5							60189	24536	35054	59209	25240	34074	79041	34491	53906	59209	25240	34074
HY-B5-801-SRC6													70523	28181	39104	74011	31550	42592
HY-B5-901-SRC4	61522	25240	36387	59209	25240	34074	85421	37860	60285	59209	25240	34074	109319	50479	84184	59209	25240	34074
HY-B5-901-SRC5							76902	31550	45483	74011	31550	42592	100801	44169	69382	74011	31550	42592
HY-B5-901-SRC6													92283	37860	54580	88813	37860	51110
HY-B6-801-SRC4	65176	26739	38729	62545	26739	36098	90495	40108	64047	62545	26739	36098	115813	53478	89365	62545	26739	36098
HY-B6-801-SRC5							80809	32934	47266	79327	33913	45783	106128	46304	72584	79327	33913	45783
HY-B6-801-SRC6													94682	37825	52752	99158	42392	57229
HY-B6-901-SRC4	82663	33913	49120	79327	33913	45783	114775	50870	81231	79327	33913	45783	146887	67826	113343	79327	33913	45783
HY-B6-901-SRC5							103329	42392	61400	99158	42392	57229	135441	59348	93511	99158	42392	57229
HY-B6-901-SRC6													121910	49325	70067	122603	52414	70759
HY-B6-1001-SRC4	101587	41472	59657	99158	42392	57229	141291	62437	99361	99158	42392	57229	180995	83403	139065	99158	42392	57229
HY-B6-1001-SRC5							127760	52414	75917	122603	52414	70759	167464	73380	115621	122603	52414	70759
HY-B6-1001-SRC6													153312	62897	91100	147123	62897	84911

The torque of the springs can be customized to your needs.  
可以根据需要定制弹簧数据。

## Output Torque of HY -B Series Actuator with Spring Return (FO)

### HY -B系列气动执行器单作用输出扭矩 (FO)

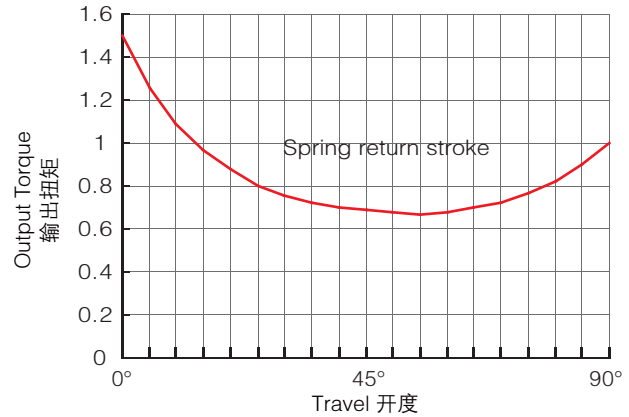
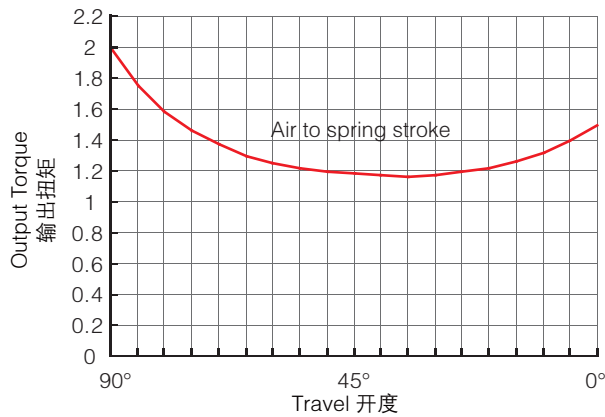

Model	Air to Spring (4Bar)			Spring			Air to Spring (5Bar)			Spring			Air to Spring (6Bar)			Spring		
	0°	45°	90°	90°	45°	0°	0°	45°	90°	90°	45°	0°	0°	45°	90°	90°	45°	0°
HY-B06-201-SRO4	549	383	934	517	383	902	911	575	1296	517	383	902	1274	766	1659	517	383	902
HY-B06-201-SRO5							686	479	1167	646	479	1128	1049	670	1530	646	479	1128
HY-B06-201-SRO6													806	567	1391	785	582	1370
HY-B06-221-SRO4	635	452	1116	646	479	1128	1076	685	1557	646	479	1128	1516	917	1997	646	479	1128
HY-B06-221-SRO5							833	582	1418	785	582	1370	1274	814	1858	785	582	1370
HY-B06-221-SRO6													1000	698	1701	942	698	1644
HY-B08-221-SRO4	834	587	1449	837	620	1452	1405	889	2020	837	620	1452	1976	1190	2591	837	620	1452
HY-B08-221-SRO5							1075	748	1830	1027	761	1782	1646	1049	2401	1027	761	1782
HY-B08-221-SRO6													1180	850	2132	1296	960	2248
HY-B08-251-SRO4	1188	807	1943	1027	761	1782	1930	1199	2685	1027	761	1782	2673	1591	3428	1027	761	1782
HY-B08-251-SRO5							1464	1000	2416	1296	960	2248	2207	1392	3159	1296	960	2248
HY-B08-251-SRO6													1633	1147	2828	1627	1205	2822
HY-B08-281-SRO4	1493	1016	2445	1296	960	2248	2429	1509	3381	1296	960	2248	3364	2003	4316	1296	960	2248
HY-B08-281-SRO5							1855	1264	3050	1627	1205	2822	2790	1758	3985	1627	1205	2822
HY-B08-281-SRO6													2142	1481	3612	2000	1482	3470
HY-B1-281-SRO4	1670	1157	2821	1563	1158	2714	2766	1736	3917	1563	1158	2714	3862	2315	5013	1563	1158	2714
HY-B1-281-SRO5							2004	1411	3478	2002	1483	3476	3100	1990	4574	2002	1483	3476
HY-B1-281-SRO6													2305	1651	4116	2460	1822	4271
HY-B1-321-SRO4	2278	1556	3752	2002	1483	3476	3717	2315	5191	2002	1483	3476	5155	3075	6629	2002	1483	3476
HY-B1-321-SRO5							2922	1976	4733	2460	1822	4271	4360	2736	6171	2460	1822	4271
HY-B1-321-SRO6													3034	2171	5408	3223	2387	5597
HY-B1-351-SRO4	2631	1822	4442	2460	1822	4271	4356	2734	6167	2460	1822	4271	6081	3645	7892	2460	1822	4271
HY-B1-351-SRO5							3030	2169	5404	3223	2387	5597	4755	3080	7129	3223	2387	5597
HY-B1-351-SRO6													3356	2483	6323	4029	2984	6996
HY-B1-401-SRO4	3445	2388	5819	3223	2387	5597	5706	3582	8080	3223	2387	5597	7966	4775	10340	3223	2387	5597
HY-B1-401-SRO5							4307	2985	7274	4029	2984	6996	6567	4178	9534	4029	2984	6996
HY-B1-401-SRO6													5168	3581	8729	4834	3581	8395
HY-B2-401-SRO4	4110	2848	6943	3846	2849	6679	6807	4273	9640	3846	2849	6679	9505	5697	12338	3846	2849	6679
HY-B2-401-SRO5							5005	3505	8603	4883	3617	8481	7703	4929	11301	4883	3617	8481
HY-B2-401-SRO6													5582	4024	10080	6104	4522	10602



Model	Air to Spring (4Bar)			Spring			Air to Spring (5Bar)			Spring			Air to Spring (6Bar)			Spring		
	0°	45°	90°	90°	45°	0°	0°	45°	90°	90°	45°	0°	0°	45°	90°	90°	45°	0°
HY-B2-451-SRO4	5219	3618	8817	4883	3617	8481	8645	5426	12243	4883	3617	8481	12070	7235	15668	4883	3617	8481
HY-B2-451-SRO5							6524	4521	11022	6104	4522	10602	9949	6330	14447	6104	4522	10602
HY-B2-451-SRO6													7829	5426	13226	7325	5426	12722
HY-B3-451-SRO4	6232	4317	10522	5828	4317	10118	10320	6475	14610	5828	4317	10118	14407	8634	18697	5828	4317	10118
HY-B3-451-SRO5							7847	5420	13186	7252	5372	12591	11934	7579	17273	7252	5372	12591
HY-B3-451-SRO6													8857	6266	15500	9025	6685	15668
HY-B3-501-SRO4	7664	5324	13003	7252	5372	12591	12727	7997	18066	7252	5372	12591	17791	10671	23130	7252	5372	12591
HY-B3-501-SRO5							9650	6684	16293	9025	6685	15668	14714	9358	21357	9025	6685	15668
HY-B3-501-SRO6													10671	7633	19028	11354	8410	19711
HY-B3-561-SRO4	9815	6771	16458	9025	6685	15668	16186	10135	22829	9025	6685	15668	22556	13499	29199	9025	6685	15668
HY-B3-561-SRO5							12143	8410	20500	11354	8410	19711	18513	11774	26870	11354	8410	19711
HY-B3-561-SRO6													14570	10092	24600	13624	10092	23654
HY-B3-631-SRO4	12619	8662	20977	11354	8410	19711	20702	12930	29059	11354	8410	19711	28784	17198	37142	11354	8410	19711
HY-B3-631-SRO5							16759	11248	26788	13264	10092	23654	24842	15516	34871	13624	10092	23654
HY-B3-631-SRO6													18486	12804	31210	17286	12804	30010
HY-B4-631-SRO4	14784	10255	24997	13844	10255	24057	24495	15383	34708	13844	10255	24057	34205	20510	44418	13844	10255	24057
HY-B4-631-SRO5							18481	12819	31246	17306	12819	30071	28191	17946	40956	17306	12819	30071
HY-B4-631-SRO6													19335	14171	35860	22402	16594	38927
HY-B4-701-SRO4	17964	12546	30730	17306	12819	30071	29973	18888	42739	17306	12819	30071	41982	25229	54748	17306	12819	30071
HY-B4-701-SRO5							21118	15113	37643	22402	16594	38927	33126	21454	49651	22402	16594	38927
HY-B4-701-SRO6													23396	17306	44052	28002	20742	48657
HY-B4-801-SRO4	23922	16594	40447	22402	16594	38927	39635	24891	56160	22402	16594	38927	55347	33188	71872	22402	16594	38927
HY-B4-801-SRO5							29904	20743	50560	28002	20742	48657	45616	29040	66272	28002	20742	48657
HY-B4-801-SRO6													35884	24891	60671	33603	24891	58390
HY-B5-801-SRO4	28703	19910	48531	26879	19910	46707	47556	29865	67384	26879	19910	46707	66408	39820	86236	26879	19910	46707
HY-B5-801-SRO5							35054	24536	60189	34074	25240	59209	53906	34491	79041	34074	25240	59209
HY-B5-801-SRO6													39104	28181	70523	42592	31550	74011
HY-B5-901-SRO4	36387	25240	61522	34074	25240	59209	60285	37860	85421	34074	25240	59209	84184	50479	109319	34074	25240	59209
HY-B5-901-SRO5							45483	31550	76902	42592	31550	74011	69382	44169	100801	42592	31550	74011
HY-B5-901-SRO6													54580	37860	92283	51110	37860	88813
HY-B6-801-SRO4	38729	26739	65176	36098	26739	62545	64047	40108	90495	36098	26739	62545	89365	53478	115813	36098	26739	62545
HY-B6-801-SRO5							47266	32934	80809	45783	33913	79327	72584	46304	106128	45783	33913	79327
HY-B6-801-SRO6													52752	37825	94682	57229	42392	99158
HY-B6-901-SRO4	49120	33913	82663	45783	33913	79327	81231	50870	114775	45783	33913	79327	113343	67826	146887	45783	33913	79327
HY-B6-901-SRO5							61400	42392	103329	57229	42392	99158	93511	59348	135441	57229	42392	99158
HY-B6-901-SRO6													70067	49325	121910	70759	52414	122603
HY-B6-1001-SRO4	59657	41472	101587	57229	42392	99158	99361	62437	141291	57229	42392	99158	139065	83403	180995	57229	42392	99158
HY-B6-1001-SRO5							75917	52414	127760	70759	52414	122603	115621	73380	167464	70759	52414	122603
HY-B6-1001-SRO6													91100	62897	153312	84911	62897	147123

The torque of the springs can be customized to your needs.  
可以根据需要定制弹簧数据。

## Output Torque of HY-C Series Actuator with Spring Return (FC)

### HY-C系列气动执行器单作用输出扭矩 (FC)

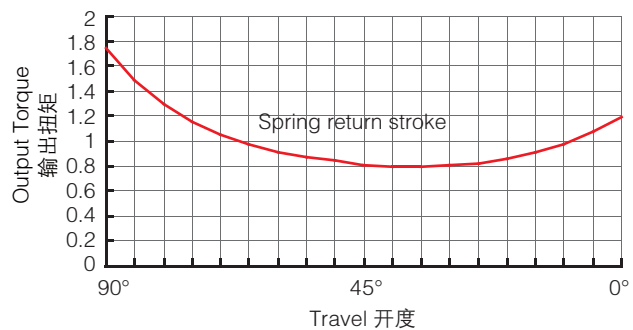
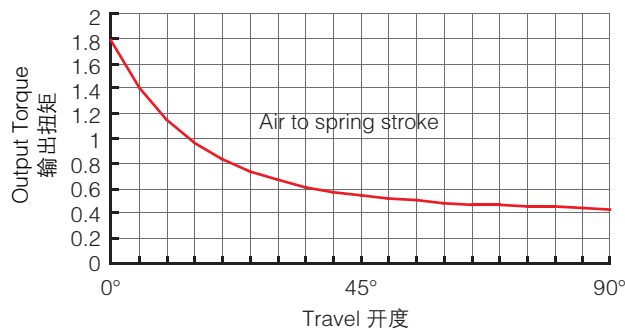

Model	Air to Spring (4Bar)			Spring			Air to Spring (5Bar)			Spring			Air to Spring (6Bar)			Spring		
	0°	45°	90°	90°	45°	0°	0°	45°	90°	90°	45°	0°	0°	45°	90°	90°	45°	0°
HY-C06-201-SRC4	870	279	305	915	479	870	1306	468	610	915	479	870	1741	658	915	915	479	870
HY-C06-201-SRC5							1088	348	381	1144	599	1088	1523	538	686	1144	599	1088
HY-C06-201-SRC6													1290	409	440	1390	728	1322
HY-C06-221-SRC4	1027	322	338	1144	599	1088	1556	552	708	1144	599	1088	2084	782	1079	1144	599	1088
HY-C06-221-SRC5							1322	423	463	1390	728	1322	1851	653	833	1390	728	1322
HY-C06-221-SRC6													1586	508	555	1668	874	1586
HY-C08-221-SRC4	1353	427	460	1462	768	1390	2038	725	941	1462	768	1390	2724	1024	1421	1462	768	1390
HY-C08-221-SRC5							1680	527	564	1838	966	1748	2366	826	1045	1838	966	1748
HY-C08-221-SRC6													1887	561	541	2342	1230	2227
HY-C08-251-SRC4	1816	586	659	1838	966	1748	2707	974	1284	1838	966	1748	3598	1362	1908	1838	966	1748
HY-C08-251-SRC5							2227	710	780	2342	1230	2227	3118	1098	1404	2342	1230	2227
HY-C08-251-SRC6													2606	814	865	2882	1513	2740
HY-C08-281-SRC4	2262	725	804	2342	1230	2227	3385	1213	1591	2342	1230	2227	4507	1702	2377	2342	1230	2227
HY-C08-281-SRC5							2872	930	1051	2882	1513	2740	3994	1419	1838	2882	1513	2740
HY-C08-281-SRC6													3367	1073	1179	3541	1860	3367
HY-C1-281-SRC4	2630	839	921	2766	1452	2630	3946	1411	1842	2766	1452	2630	5261	1984	2764	2766	1452	2630
HY-C1-281-SRC5							3206	1003	1065	3544	1861	3370	4521	1576	1986	3544	1861	3370
HY-C1-281-SRC6													3750	1150	1176	4355	2286	4141
HY-C1-321-SRC4	3535	1146	1295	3544	1861	3370	5261	1898	2505	3544	1861	3370	6988	2650	3715	3544	1861	3370
HY-C1-321-SRC5							4490	1472	1694	4355	2286	4141	6217	2224	2904	4355	2286	4141
HY-C1-321-SRC6													5098	1606	1727	5532	2904	5260
HY-C1-351-SRC4	4141	1320	1449	4355	2286	4141	6211	2222	2900	4355	2286	4141	8282	3123	4351	4355	2286	4141
HY-C1-351-SRC5							5092	1604	1724	5532	2904	5260	7163	2506	3175	5532	2904	5260
HY-C1-351-SRC6													5927	1823	1875	6832	3586	6496
HY-C1-401-SRC4	5591	1821	2073	5532	2904	5260	8303	3002	3974	5532	2904	5260	11016	4184	5875	5532	2904	5260
HY-C1-401-SRC5							7067	2320	2674	6832	3586	6496	9780	3501	4575	6832	3586	6496
HY-C1-401-SRC6													8138	2595	2848	8559	4493	8138
HY-C2-401-SRC4	6473	2064	2266	6808	3574	6473	9710	3474	4534	6808	3574	6473	12947	4883	6803	6808	3574	6473
HY-C2-401-SRC5							7963	2509	2697	8645	4538	8220	11200	3919	4965	8645	4538	8220
HY-C2-401-SRC6													9428	2941	3102	10508	5516	9992

Model	Air to Spring (4Bar)			Spring			Air to Spring (5Bar)			Spring			Air to Spring (6Bar)			Spring		
	0°	45°	90°	90°	45°	0°	0°	45°	90°	90°	45°	0°	0°	45°	90°	90°	45°	0°
HY-C2-451-SRC4	8220	2621	2877	8645	4538	8220	12330	4411	5758	8645	4538	8220	16441	6201	8638	8645	4538	8220
HY-C2-451-SRC5							10559	3433	3894	10508	5516	9992	14669	5223	6775	10508	5516	9992
HY-C2-451-SRC6													12330	3932	4316	12967	6807	12330
HY-C3-451-SRC4	9810	3127	3434	10317	5417	9810	14715	5263	6871	10317	5417	9810	19620	7399	10309	10317	5417	9810
HY-C3-451-SRC5							12263	3909	4292	12896	6771	12263	17168	6045	7730	12896	6771	12263
HY-C3-451-SRC6													14239	4428	4650	15976	8388	15191
HY-C3-501-SRC4	12043	3813	4138	12896	6771	12263	18120	6459	8397	12896	6771	12263	24196	9105	12655	12896	6771	12263
HY-C3-501-SRC5							15191	4842	5317	15976	8388	15191	21267	7489	9575	15976	8388	15191
HY-C3-501-SRC6													17346	5324	5452	20100	10553	19112
HY-C3-561-SRC4	15388	4928	5455	15976	8388	15191	23033	8257	10813	15976	8388	15191	30678	11586	16171	15976	8388	15191
HY-C3-561-SRC5							19112	6092	6689	20100	10553	19112	26757	9421	12047	20100	10553	19112
HY-C3-561-SRC6													23896	7842	9039	23108	12132	21973
HY-C3-631-SRC4	19809	6396	7177	20100	10553	19112	29539	10633	13997	20100	10553	19112	39269	14870	20816	20100	10553	19112
HY-C3-631-SRC5							23305	7191	7441	26656	13995	25346	33035	11428	14260	26656	13995	25346
HY-C3-631-SRC6													29191	9305	10217	30699	16118	29191
HY-C4-631-SRC4	21759	6584	6531	26135	13712	24851	33411	11658	14697	26135	13712	24851	45063	16732	22863	26135	13712	24851
HY-C4-631-SRC5							29131	9297	10196	30636	16074	29131	40783	14371	18362	30636	16074	29131
HY-C4-631-SRC6													33888	10566	11110	37888	19879	36027
HY-C4-701-SRC4	28512	9027	9762	30636	16074	29131	42922	15302	19861	30636	16074	29131	57333	21578	29961	30636	16074	29131
HY-C4-701-SRC5							36027	11497	12609	37888	19879	36027	50437	17773	22709	37888	19879	36027
HY-C4-701-SRC6													41280	12719	13078	47519	24932	45184
HY-C4-801-SRC4	39392	12963	14968	37888	19879	36027	58247	21173	28182	37888	19879	36027	77102	29384	41396	37888	19879	36027
HY-C4-801-SRC5							49089	16120	18551	47519	24932	45184	67944	24331	31765	47519	24932	45184
HY-C4-801-SRC6													56564	18052	19798	59487	31211	56564
HY-C5-801-SRC4	45246	14438	15836	47584	24968	45246	67869	24289	31691	47584	24968	45246	90492	34141	47546	47584	24968	45246
HY-C5-801-SRC5							55758	17606	18954	60321	31651	57357	78381	27457	34809	60321	31651	57357
HY-C5-801-SRC6													65955	20601	21742	73388	38508	69783
HY-C5-901-SRC4	57357	18302	20075	60321	31651	57357	86036	30791	40174	60321	31651	57357	114714	43279	60273	60321	31651	57357
HY-C5-901-SRC5							73610	23934	27106	73388	38508	69783	102289	36423	47205	73388	38508	69783
HY-C5-901-SRC6													86036	27454	30113	90481	47477	86036
HY-C6-801-SRC4	60764	19336	21267	63904	33585	60764	91146	32566	42560	63904	33585	60764	121528	45796	63853	63904	33585	60764
HY-C6-801-SRC5							74843	23555	25414	81050	42596	77068	105225	36785	46707	81050	42596	77068
HY-C6-801-SRC6													88036	27284	28630	99127	52097	94257
HY-C6-901-SRC4	77068	24524	26974	81050	42596	77068	115602	41304	53980	81050	42596	77068	154136	58084	80985	81050	42596	77068
HY-C6-901-SRC5							98413	31803	35902	99127	52097	94257	136946	48583	62908	99127	52097	94257
HY-C6-901-SRC6													113847	35815	38615	123420	64864	117357
HY-C6-1001-SRC4	96322	30893	34437	99127	52097	94257	143967	51640	67828	99127	52097	94257	191611	72387	101219	99127	52097	94257
HY-C6-1001-SRC5							120867	38872	43535	123420	64864	117357	168511	59620	76926	123420	64864	117357
HY-C6-1001-SRC6													142934	45483	50027	150319	79001	142934

The torque of the springs can be customized to your needs.  
可以根据需要定制弹簧数据。

## Output Torque of HY-C Series Actuator with Spring Return (FO)

### HY-C系列气动执行器单作用输出扭矩 (FO)

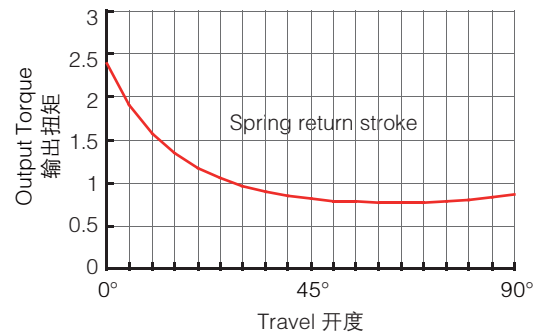
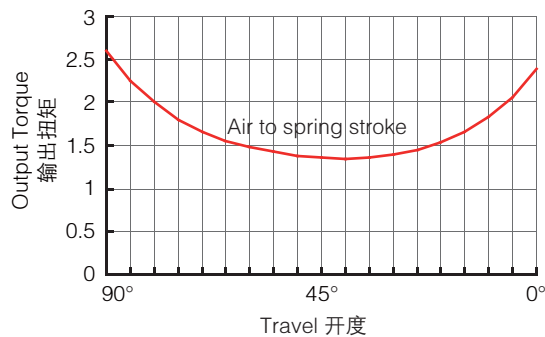

Model	Air to Spring (4Bar)			Spring			Air to Spring (5Bar)			Spring			Air to Spring (6Bar)			Spring		
	0°	45°	90°	90°	45°	0°	0°	45°	90°	90°	45°	0°	0°	45°	90°	90°	45°	0°
HY-C06-201-SRO4	870	471	915	305	287	870	1306	660	1221	305	287	870	1741	850	1526	305	287	870
HY-C06-201-SRO5							1088	589	1144	381	359	1088	1523	778	1449	381	359	1088
HY-C06-201-SRO6													1290	701	1368	463	436	1322
HY-C06-221-SRO4	1027	562	1101	381	359	1088	1556	792	1472	381	359	1088	2084	1023	1843	381	359	1088
HY-C06-221-SRO5							1322	715	1390	463	436	1322	1851	945	1761	463	436	1322
HY-C06-221-SRO6													1586	858	1668	555	523	1586
HY-C08-251-SRO4	1353	735	1436	487	459	1390	2038	1033	1916	487	459	1390	2724	1332	2397	487	459	1390
HY-C08-251-SRO5							1699	921	1798	605	572	1729	2385	1220	2278	605	572	1729
HY-C08-251-SRO6													1887	1055	2104	780	736	2227
HY-C08-251-SRO4	1835	980	1892	605	572	1729	2726	1368	2517	605	572	1729	3617	1756	3141	605	572	1729
HY-C08-251-SRO5							2227	1204	2342	780	736	2227	3118	1591	2967	780	736	2227
HY-C08-251-SRO6													2606	1422	2787	959	906	2740
HY-C08-281-SRO4	2262	1219	2367	780	736	2227	3385	1707	3153	780	736	2227	4507	2196	3940	780	736	2227
HY-C08-281-SRO5							2872	1538	2974	959	906	2740	3994	2027	3761	959	906	2740
HY-C08-281-SRO6													3367	1819	3541	1179	1113	3367
HY-C1-281-SRO4	2630	1422	2766	921	869	2630	3946	1994	3688	921	869	2630	5261	2567	4610	921	869	2630
HY-C1-281-SRO5							3205	1750	3429	1180	1114	3371	4520	2322	4351	1180	1114	3371
HY-C1-281-SRO6													3663	2039	4051	1480	1397	4228
HY-C1-321-SRO4	3534	1893	3659	1180	1114	3371	5260	2645	4869	1180	1114	3371	6987	3396	6079	1180	1114	3371
HY-C1-321-SRO5							4403	2361	4569	1480	1397	4228	6130	3113	5779	1480	1397	4228
HY-C1-321-SRO6													5058	2759	5404	1855	1751	5300
HY-C1-351-SRO4	4054	2209	4324	1480	1397	4228	6124	3111	5776	1480	1397	4228	8195	4013	7227	1480	1397	4228
HY-C1-351-SRO5							5052	2757	5400	1855	1751	5300	7123	3658	6851	1855	1751	5300
HY-C1-351-SRO6													5926	3263	6432	2274	2147	6497
HY-C1-401-SRO4	5551	2974	5750	1855	1751	5300	8263	4155	7651	1855	1751	5300	10976	5336	9552	1855	1751	5300
HY-C1-401-SRO5							7066	3759	7232	2274	2147	6497	9779	4941	9133	2274	2147	6497
HY-C1-401-SRO6													8138	4398	8559	2848	2689	8138
HY-C2-401-SRO4	6473	3499	6808	2266	2139	6473	9710	4908	9076	2266	2139	6473	12947	6318	11345	2266	2139	6473
HY-C2-401-SRO5							8028	4352	8487	2855	2695	8156	11264	5762	10756	2855	2695	8156
HY-C2-401-SRO6													9420	5153	10110	3500	3304	10000

Model	Air to Spring (4Bar)			Spring			Air to Spring (5Bar)			Spring			Air to Spring (6Bar)			Spring		
	0°	45°	90°	90°	45°	0°	0°	45°	90°	90°	45°	0°	0°	45°	90°	90°	45°	0°
HY-C2-451-SRO4	8285	4464	8667	2855	2695	8156	12395	6254	11548	2855	2695	8156	16505	8044	14429	2855	2695	8156
HY-C2-451-SRO5							10551	5645	10903	3500	3304	10000	14661	7435	13783	3500	3304	10000
HY-C2-451-SRO6													12330	6665	12967	4316	4074	12330
HY-C3-451-SRO4	9810	5302	10317	3434	3242	9810	14715	7438	13755	3434	3242	9810	19620	9574	17192	3434	3242	9810
HY-C3-451-SRO5							12263	6627	12896	4292	4052	12263	17168	8763	16334	4292	4052	12263
HY-C3-451-SRO6													14239	7796	15309	5317	5020	15191
HY-C3-501-SRO4	12043	6532	12742	4292	4052	12263	18120	9178	17001	4292	4052	12263	24196	11824	21259	4292	4052	12263
HY-C3-501-SRO5							15191	8210	15976	5317	5020	15191	21267	10856	20234	5317	5020	15191
HY-C3-501-SRO6													18152	9826	19144	6407	6050	18307
HY-C3-561-SRO4	15388	8296	16114	5317	5020	15191	23033	11625	21472	5317	5020	15191	30678	14954	26830	5317	5020	15191
HY-C3-561-SRO5							19917	10595	20381	6407	6050	18307	27562	13924	25739	6407	6050	18307
HY-C3-561-SRO6													23896	12713	24456	7690	7261	21973
HY-C3-631-SRO4	16948	9687	19587	7690	7261	21973	26678	13924	26406	7690	7261	21973	36408	18161	33225	7690	7261	21973
HY-C3-631-SRO5							23305	12810	25225	88718	8376	25346	33035	17047	32044	8871	8376	25346
HY-C3-631-SRO6													29191	15776	30699	10217	9646	29191
HY-C4-631-SRO4	21759	12090	23968	8698	8206	24851	33411	17164	32134	8698	8206	24851	45063	22239	40300	8698	8206	24851
HY-C4-631-SRO5							28386	15505	30375	10457	9866	29876	40038	20579	38542	10457	9866	29876
HY-C4-631-SRO6													33888	18548	36389	12609	11897	36027
HY-C4-701-SRO4	27767	15235	29941	10457	9866	29876	42177	21511	40041	10457	9866	29876	56588	27786	50140	10457	9866	29876
HY-C4-701-SRO5							36027	19480	37888	12609	11897	36027	50437	25755	47988	12609	11897	36027
HY-C4-701-SRO6													41280	22731	44783	15814	14921	45184
HY-C4-801-SRO4	39392	20945	40247	12609	11897	36027	58247	29156	53461	12609	11897	36027	77102	37366	66675	12609	11897	36027
HY-C4-801-SRO5							49090	26132	50256	15814	14921	45184	67945	34342	63470	15814	14921	45184
HY-C4-801-SRO6													56564	30584	59487	19798	18679	56564
HY-C5-801-SRO4	45246	24463	47584	15836	14943	45246	67869	34314	63439	15836	14943	45246	90492	44165	79294	15836	14943	45246
HY-C5-801-SRO5							55758	30314	59200	20075	18943	57357	78381	40166	75055	20075	18943	57357
HY-C5-801-SRO6													65956	36062	70706	24424	23046	69782
HY-C5-901-SRO4	57357	31011	60321	20075	18943	57357	86036	43499	80420	20075	18943	57357	114714	55987	100518	20075	18943	57357
HY-C5-901-SRO5							73611	39396	76071	24424	23046	69782	102290	51884	96170	24424	23046	69782
HY-C5-901-SRO6													86036	46516	90481	30113	28414	86036
HY-C6-801-SRO4	60764	32823	63904	21267	20097	60764	91146	46054	85197	21267	20097	60764	121528	59284	106489	21267	20097	60764
HY-C6-801-SRO5							74843	40661	79490	26974	25490	77068	105225	53891	100783	26974	25490	77068
HY-C6-801-SRO6													85958	47519	94040	33717	31862	96335
HY-C6-901-SRO4	77068	41630	81050	26974	25490	77068	115602	58410	108055	26974	25490	77068	154136	75190	135061	26974	25490	77068
HY-C6-901-SRO5							96335	52038	101312	33717	31862	96335	134869	68818	128318	33717	31862	96335
HY-C6-901-SRO6													112092	61284	120346	41689	39396	119112
HY-C6-1001-SRO4	94244	51127	99847	33717	31862	96335	141889	71875	133238	33717	31862	96335	189533	92622	166629	33717	31862	96335
HY-C6-1001-SRO5							119112	64341	125266	41689	39396	119112	166756	85089	158657	41689	39396	119112
HY-C6-1001-SRO6													142934	77210	150319	50027	47275	142934

The torque of the springs can be customized to your needs.  
可以根据需要定制弹簧数据。

## Sizing 选型

在执行器的选型过程中，如果能够了解阀门在选型、运行过程所需扭矩的状况，我们就可以更加经济、更加合理地选配执行器。  
During selecting the actuators, we can choose the more reasonable and more economical actuators, if we know the different torque needed by the valve working at opening and operating.

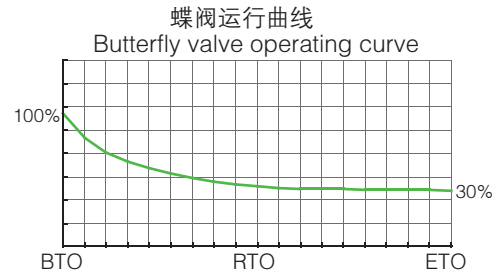
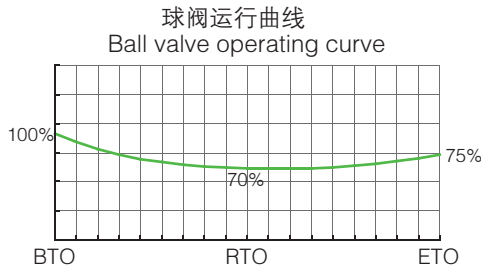

■ 弹簧复位运行曲线  
Spring return operating curve

■ 执行器运行曲线  
Air to spring operating curve

■ 球阀(蝶阀)运行曲线  
Ball valve (butterfly valve) operating curve

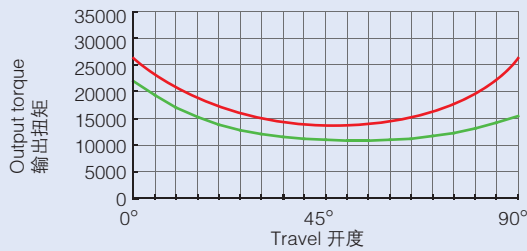

球阀选型扭矩为: 22000Nm  
Air Supply: 4 Bar  
选型结果: HY-B3-561-DA  
BTO of the ball valve is: 22000Nm  
Air Failure Position: Lock  
Sizing: HY-B3-561-DA

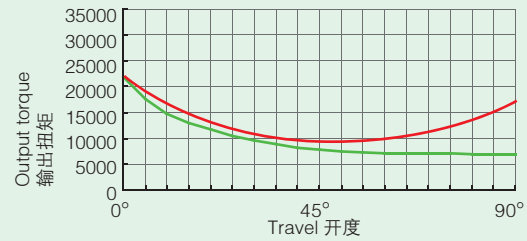

蝶阀选型扭矩为: 22000Nm  
Air Supply: 4 Bar  
选型结果: HY-C3-501-DA  
BTO of the butterfly valve is: 22000Nm  
Air Failure Position: Lock  
Sizing: HY-C3-501-DA

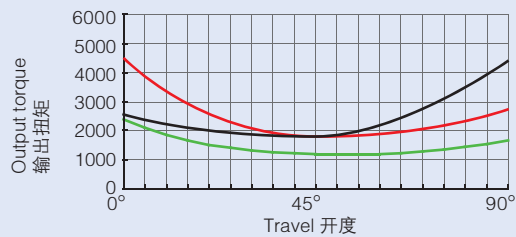

球阀选型扭矩为: 2400Nm  
Air Supply: 4 Bar  
选型结果: HY-B1-351-SRC4  
BTO of the ball valve is: 2400Nm  
Air Failure Position: Close  
Sizing: HY-B1-351-SRC4

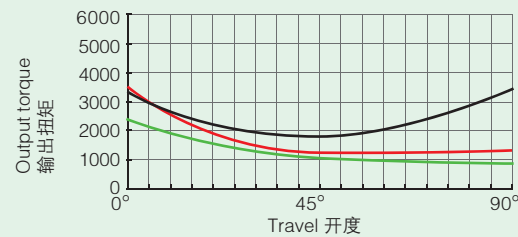

蝶阀选型扭矩为: 2400Nm  
Air Supply: 4 Bar  
选型结果: HY-C1-321-SRC4  
BTO of the butterfly valve is: 2400Nm  
Air Failure Position: Close  
Sizing: HY-C1-321-SRC4

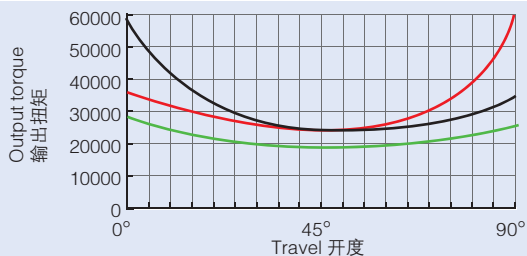

球阀选型扭矩为: 29000Nm  
Air Supply: 4 Bar  
选型结果: HY-B5-901-SRO4  
BTO of the ball valve is: 29000Nm  
Air Failure Position: Open  
Sizing: HY-B5-901-SRO4

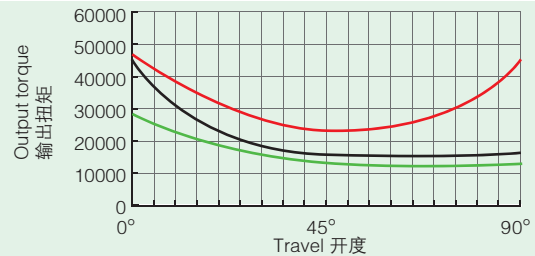

蝶阀选型扭矩为: 29000Nm  
Air Supply: 4 Bar  
选型结果: HY-C5-801-SRO4  
BTO of the butterfly valve is: 29000Nm  
Air Failure Position: Open  
Sizing: HY-C5-801-SRO4

## Dimension of HY - B(C)Series Double Acting Actuator

### HY - B(C)双作用执行器外形尺寸

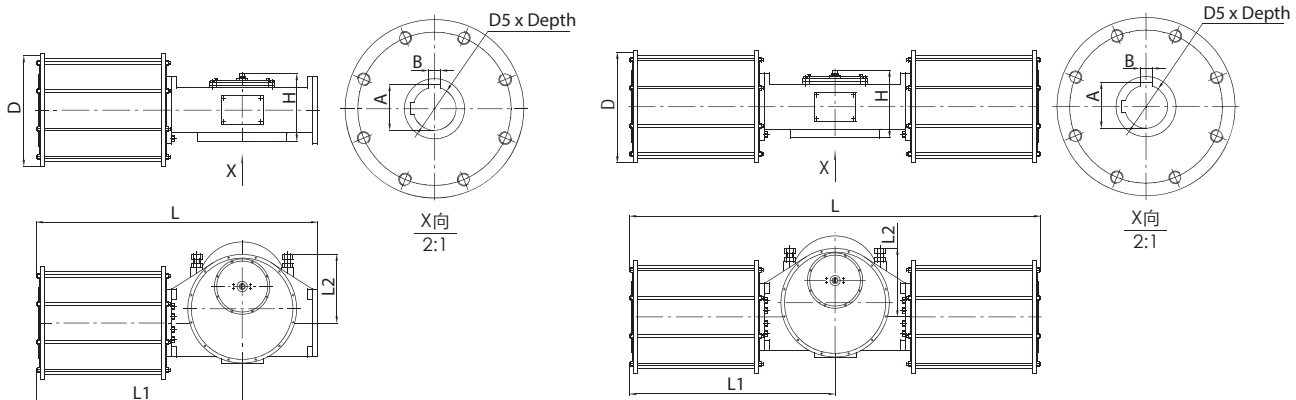

Model 型号	L	L1	L2	H	D	D5	A	B	Connecting Flange	Air Connection	
									连接法兰	气源接口	
mm										ISO 5211	
HY-B/C06-201-DA	675	505	180	212	225*225	Ø48*65	51.8	14	F14	3/8"G(NPT)	
HY-B/C08-221-DA	815	605	200	237	250*250	Ø60*100	64.4	18	F16	1/2"G(NPT)	
HY-B08-251-DA	815	605	200	237	280*280	Ø60*100	64.4	18	F16	1/2"G(NPT)	
HY-B/C1-281-DA	925	680	225	246	310*310	Ø72*120	76.9	20	F25/F16	1/2"G(NPT)	
HY-B/C1-321-DA	905	660	225	246	Ø395	Ø72*120	76.9	20	F25/F16	1/2"G(NPT)	
HY-B1-351-DA	905	660	225	246	Ø430	Ø72*120	76.9	20	F25/F16	3/4"G(NPT)	
HY-B/C2-351-DA	1055	775	285	269	Ø430	Ø100*150	106.4	28	F30/F25	3/4"G(NPT)	
HY-B/C2-401-DA	1055	775	285	269	Ø500	Ø100*150	106.4	28	F30/F25	1"G(NPT)	
HY-B/C2-451-DA	1055	775	285	269	Ø550	Ø100*150	106.4	28	F30/F25	1"G(NPT)	
HY-B/C3-451-DA	1250	915	330	310	Ø550	Ø160*200	169.4	40	F35/F30	1"G(NPT)	
HY-B/C3-501-DA	1250	915	330	310	Ø600	Ø160*200	169.4	40	F35/F30	1 1/4"G(NPT)	
HY-B/C3-561-DA	1250	915	330	310	Ø660	Ø160*200	169.4	40	F35/F30	1 1/4"G(NPT)	
HY-B3-601-DA	1250	915	330	310	Ø700	Ø160*200	169.4	40	F35/F30	1 1/4"G(NPT)	
HY-C4-561-DA	1450	1050	412	340	Ø660	Ø180*220	190.4	45	F40	1 1/4"G(NPT)	
HY-B/C4-601-DA	1450	1050	412	340	Ø700	Ø180*220	190.4	45	F40	1 1/4"G(NPT)	
HY-B/C4-631-DA	1450	1050	412	340	Ø730	Ø180*220	190.4	45	F40	1 1/2"G(NPT)	
HY-B/C4-701-DA	1450	1050	412	340	Ø810	Ø180*220	190.4	45	F40	1 1/2"G(NPT)	
HY-B4-801-DA	1450	1050	412	340	Ø910	Ø180*220	190.4	45	F40	1 1/2"G(NPT)	
HY-B/C4-502-DA	2120	1050	412	340	Ø600	Ø180*220	190.4	45	F40	1 1/4"G(NPT)	
HY-B4-562-DA	2120	1050	412	340	Ø660	Ø180*220	190.4	45	F40	1 1/4"G(NPT)	
HY-B/C5-701-DA	1690	1230	486	420	Ø810	Ø220*250	231.4	50	F48/F40	1 1/2"G(NPT)	
HY-B/C5-801-DA	1690	1230	486	420	Ø910	Ø220*250	231.4	50	F48/F40	1 1/2"G(NPT)	
HY-B/C5-901-DA	1690	1230	486	420	Ø1010	Ø220*250	231.4	50	F48/F40	2"G(NPT)	
HY-B5-1001-DA	1690	1230	486	420	Ø1110	Ø220*250	231.4	50	F48/F40	2"G(NPT)	
HY-B/C5-562-DA	2456	1230	486	420	Ø660	Ø220*250	231.4	50	F48/F40	1 1/4"G(NPT)	
HY-B/C5-602-DA	2456	1230	486	420	Ø700	Ø220*250	231.4	50	F48/F40	1 1/4"G(NPT)	
HY-B/C5-632-DA	2456	1230	486	420	Ø730	Ø220*250	231.4	50	F48/F40	1 1/2"G(NPT)	
HY-B5-702-DA	2456	1230	486	420	Ø810	Ø220*250	231.4	50	F48/F40	1 1/2"G(NPT)	
HY-C6-801-DA	2145	1555	658	490	Ø910	Ø280*320	292.4	63	F60/F48	1 1/2"G(NPT)	
HY-B/C6-901-DA	2145	1555	658	490	Ø1010	Ø280*320	292.4	63	F60/F48	2"G(NPT)	
HY-B/C6-1001-DA	2145	1555	658	490	Ø1110	Ø280*320	292.4	63	F60/F48	2"G(NPT)	
HY-B/C6-702-DA	3100	1555	658	490	Ø810	Ø280*320	292.4	63	F60/F48	1 1/2"G(NPT)	
HY-B/C6-802-DA	3100	1555	658	490	Ø910	Ø280*320	292.4	63	F60/F48	1 1/2"G(NPT)	
HY-B6-902-DA	3100	1555	658	490	Ø1010	Ø280*320	292.4	63	F60/F48	2"G(NPT)	

The dimension of D5 can be customized according to your requirements.  
轴孔D5可以根据阀杆尺寸定制。

## Dimension of HY-B FC(O) Series Spring Return Actuator

### HY-B FC(O)单作用执行器外形尺寸

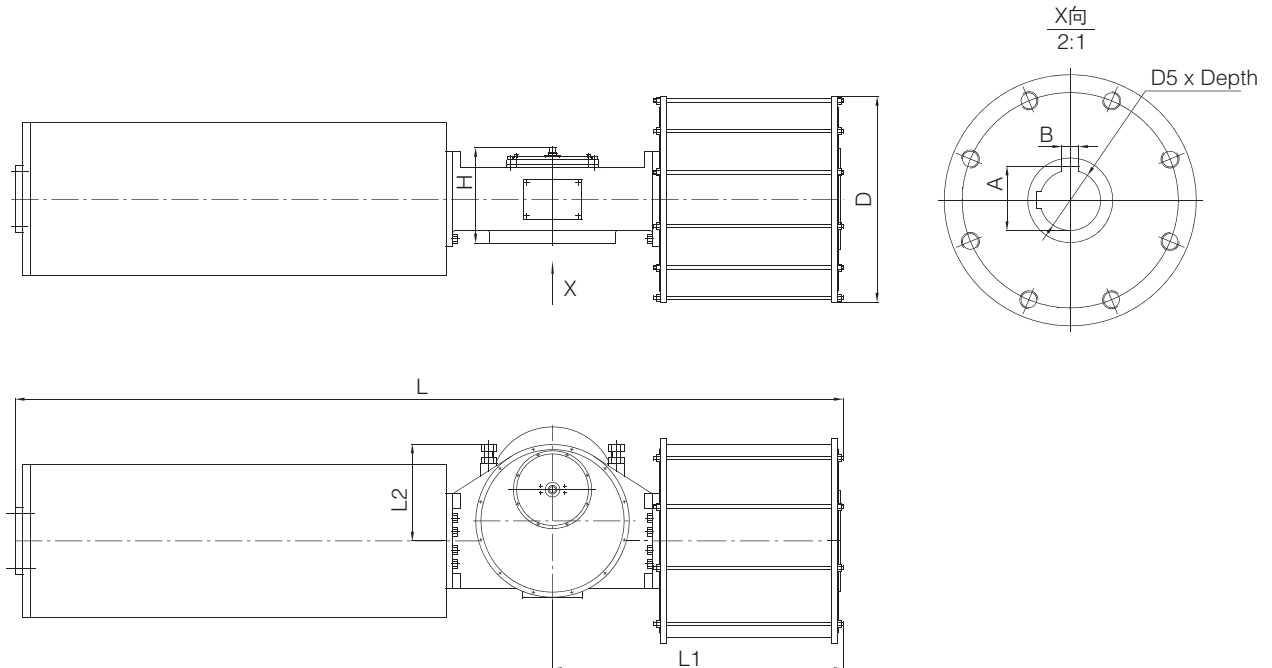

Model 型号	L	L1	L2	H	D	D5xDepth	A	B	Connecting Flange 连接法兰	Air Connection 气源接口
	mm								ISO5211	
HY-B06-201-SRO4	1304	505	175	214	□225	Ø48x65	51.8	14	F14	3/8"G(NPT)
HY-B06-201-SRO5	1354	505	175	214	□225	Ø48x65	51.8	14	F14	3/8"G(NPT)
HY-B06-201-SRO6	1374	505	175	214	□225	Ø48x65	51.8	14	F14	3/8"G(NPT)
HY-B06-221-SRO4	1354	515	175	214	□250	Ø48x65	51.8	14	F14	1/2"G(NPT)
HY-B06-221-SRO5	1374	515	175	214	□250	Ø48x65	51.8	14	F14	1/2"G(NPT)
HY-B06-221-SRO6	1324	515	175	214	□250	Ø48x65	51.8	14	F14	1/2"G(NPT)
HY-B08-221-SRO4	1458	605	200	238	□250	Ø60x100	64.4	18	F16	1/2"G(NPT)
HY-B08-221-SRO5	1488	605	200	238	□250	Ø60x100	64.4	18	F16	1/2"G(NPT)
HY-B08-221-SRO6	1528	605	200	238	□250	Ø60x100	64.4	18	F16	1/2"G(NPT)
HY-B08-251-SRO4	1488	605	200	238	□280	Ø60x100	64.4	18	F16	1/2"G(NPT)
HY-B08-251-SRO5	1528	605	200	238	□280	Ø60x100	64.4	18	F16	1/2"G(NPT)
HY-B08-251-SRO6	1528	605	200	238	□280	Ø60x100	64.4	18	F16	1/2"G(NPT)
HY-B08-281-SRO4	1528	605	200	238	□310	Ø60x100	64.4	18	F16	1/2"G(NPT)
HY-B08-281-SRO5	1528	605	200	238	□310	Ø60x100	64.4	18	F16	1/2"G(NPT)
HY-B08-281-SRO6	1558	605	200	238	□310	Ø60x100	64.4	18	F16	1/2"G(NPT)
HY-B1-281-SRO4	1660	680	225	245	□310	Ø72x120	76.9	20	F25/F16	1/2"G(NPT)
HY-B1-281-SRO5	1690	680	225	245	□310	Ø72x120	76.9	20	F25/F16	1/2"G(NPT)
HY-B1-281-SRO6	1710	680	225	245	□310	Ø72x120	76.9	20	F25/F16	1/2"G(NPT)
HY-B1-321-SRO4	1670	660	225	245	Ø395	Ø72x120	76.9	20	F25/F16	1/2"G(NPT)
HY-B1-321-SRO5	1690	660	225	245	Ø395	Ø72x120	76.9	20	F25/F16	1/2"G(NPT)
HY-B1-321-SRO6	1710	660	225	245	Ø395	Ø72x120	76.9	20	F25/F16	1/2"G(NPT)
HY-B1-351-SRO4	1690	660	225	245	Ø430	Ø72x120	76.9	20	F25/F16	3/4"G(NPT)
HY-B1-351-SRO5	1710	660	225	245	Ø430	Ø72x120	76.9	20	F25/F16	3/4"G(NPT)
HY-B1-351-SRO6	1730	660	225	245	Ø430	Ø72x120	76.9	20	F25/F16	3/4"G(NPT)



Model 型号	L	L1	L2	H	D	D5xDepth	A	B	Connecting Flange 连接法兰	Air Connection 气源接口
	mm								ISO5211	
HY-B1-401-SRO4	1710	660	225	245	Ø500	Ø72x120	76.9	20	F25/F16	1"G(NPT)
HY-B1-401-SRO5	1730	660	225	245	Ø500	Ø72x120	76.9	20	F25/F16	1"G(NPT)
HY-B1-401-SRO6	1770	660	225	245	Ø500	Ø72x120	76.9	20	F25/F16	1"G(NPT)
HY-B2-401-SRO4	1915	775	285	269	Ø500	Ø100x150	106.4	28	F30/F25	1"G(NPT)
HY-B2-401-SRO5	1965	775	285	269	Ø500	Ø100x150	106.4	28	F30/F25	1"G(NPT)
HY-B2-401-SRO6	2025	775	285	269	Ø500	Ø100x150	106.4	28	F30/F25	1"G(NPT)
HY-B2-451-SRO4	1965	775	285	269	Ø550	Ø100x150	106.4	28	F30/F25	1"G(NPT)
HY-B2-451-SRO5	2025	775	285	269	Ø550	Ø100x150	106.4	28	F30/F25	1"G(NPT)
HY-B2-451-SRO6	2045	775	285	269	Ø550	Ø100x150	106.4	28	F30/F25	1"G(NPT)
HY-B3-451-SRO4	2223	915	345	310	Ø550	Ø160x200	169.4	40	F35/F30	1"G(NPT)
HY-B3-451-SRO5	2243	915	345	310	Ø550	Ø160x200	169.4	40	F35/F30	1"G(NPT)
HY-B3-451-SRO6	2263	915	345	310	Ø550	Ø160x200	169.4	40	F35/F30	1"G(NPT)
HY-B3-501-SRO4	2243	915	345	310	Ø600	Ø160x200	169.4	40	F35/F30	1 1/4"G(NPT)
HY-B3-501-SRO5	2263	915	345	310	Ø600	Ø160x200	169.4	40	F35/F30	1 1/4"G(NPT)
HY-B3-501-SRO6	2323	915	345	310	Ø600	Ø160x200	169.4	40	F35/F30	1 1/4"G(NPT)
HY-B3-561-SRO4	2263	915	345	310	Ø660	Ø160x200	169.4	40	F35/F30	1 1/4"G(NPT)
HY-B3-561-SRO5	2323	915	345	310	Ø660	Ø160x200	169.4	40	F35/F30	1 1/4"G(NPT)
HY-B3-561-SRO6	2383	915	345	310	Ø660	Ø160x200	169.4	40	F35/F30	1 1/4"G(NPT)
HY-B3-631-SRO4	2383	915	345	310	Ø730	Ø160x200	169.4	40	F35/F30	1 1/2"G(NPT)
HY-B3-631-SRO5	2383	915	345	310	Ø730	Ø160x200	169.4	40	F35/F30	1 1/2"G(NPT)
HY-B3-631-SRO6	2423	915	345	310	Ø730	Ø160x200	169.4	40	F35/F30	1 1/2"G(NPT)
HY-B4-631-SRO4	2784	1050	412	340	Ø730	Ø180x220	190.4	45	F40	1 1/2"G(NPT)
HY-B4-631-SRO5	2784	1050	412	340	Ø730	Ø180x220	190.4	45	F40	1 1/2"G(NPT)
HY-B4-631-SRO6	2924	1050	412	340	Ø730	Ø180x220	190.4	45	F40	1 1/2"G(NPT)
HY-B4-701-SRO4	2784	1050	412	340	Ø810	Ø180x220	190.4	45	F40	1 1/2"G(NPT)
HY-B4-701-SRO5	2924	1050	412	340	Ø810	Ø180x220	190.4	45	F40	1 1/2"G(NPT)
HY-B4-701-SRO6	3014	1050	412	340	Ø810	Ø180x220	190.4	45	F40	1 1/2"G(NPT)
HY-B4-801-SRO4	2924	1050	412	340	Ø910	Ø180x220	190.4	45	F40	1 1/2"G(NPT)
HY-B4-801-SRO5	3014	1050	412	340	Ø910	Ø180x220	190.4	45	F40	1 1/2"G(NPT)
HY-B4-801-SRO6	3100	1050	412	340	Ø910	Ø180x220	190.4	45	F40	1 1/2"G(NPT)
HY-B5-801-SRO4	3273	1230	486	420	Ø910	Ø220x250	231.4	50	F48/F40	1 1/2"G(NPT)
HY-B5-801-SRO5	3333	1230	486	420	Ø910	Ø220x250	231.4	50	F48/F40	1 1/2"G(NPT)
HY-B5-801-SRO6	3453	1230	486	420	Ø910	Ø220x250	231.4	50	F48/F40	1 1/2"G(NPT)
HY-B5-901-SRO4	3333	1230	486	420	Ø1010	Ø220x250	231.4	50	F48/F40	2"G(NPT)
HY-B5-901-SRO5	3453	1230	486	420	Ø1010	Ø220x250	231.4	50	F48/F40	2"G(NPT)
HY-B5-901-SRO6	3613	1230	486	420	Ø1010	Ø220x250	231.4	50	F48/F40	2"G(NPT)
HY-B6-801-SRO4	4070	1555	658	490	Ø910	Ø280x320	292.4	63	F60/F48	1 1/2"G(NPT)
HY-B6-801-SRO5	4200	1555	658	490	Ø910	Ø280x320	292.4	63	F60/F48	1 1/2"G(NPT)
HY-B6-801-SRO6	4260	1555	658	490	Ø910	Ø280x320	292.4	63	F60/F48	1 1/2"G(NPT)
HY-B6-901-SRO4	4200	1555	658	490	Ø1010	Ø280x320	292.4	63	F60/F48	2"G(NPT)
HY-B6-901-SRO5	4260	1555	658	490	Ø1010	Ø280x320	292.4	63	F60/F48	2"G(NPT)
HY-B6-901-SRO6	4320	1555	658	490	Ø1010	Ø280x320	292.4	63	F60/F48	2"G(NPT)
HY-B6-1001-SRO4	4260	1555	658	490	Ø1110	Ø280x320	292.4	63	F60/F48	2"G(NPT)
HY-B6-1001-SRO5	4320	1555	658	490	Ø1110	Ø280x320	292.4	63	F60/F48	2"G(NPT)
HY-B6-1001-SRO6	4380	1555	658	490	Ø1110	Ø280x320	292.4	63	F60/F48	2"G(NPT)

The dimension of D5 can be customized according to your requirements.  
轴孔D5可以根据阀杆尺寸定制。

### Dimension of HY-C (FC)Series Spring Return Actuator

#### HY-C (FC)单作用执行器外形尺寸

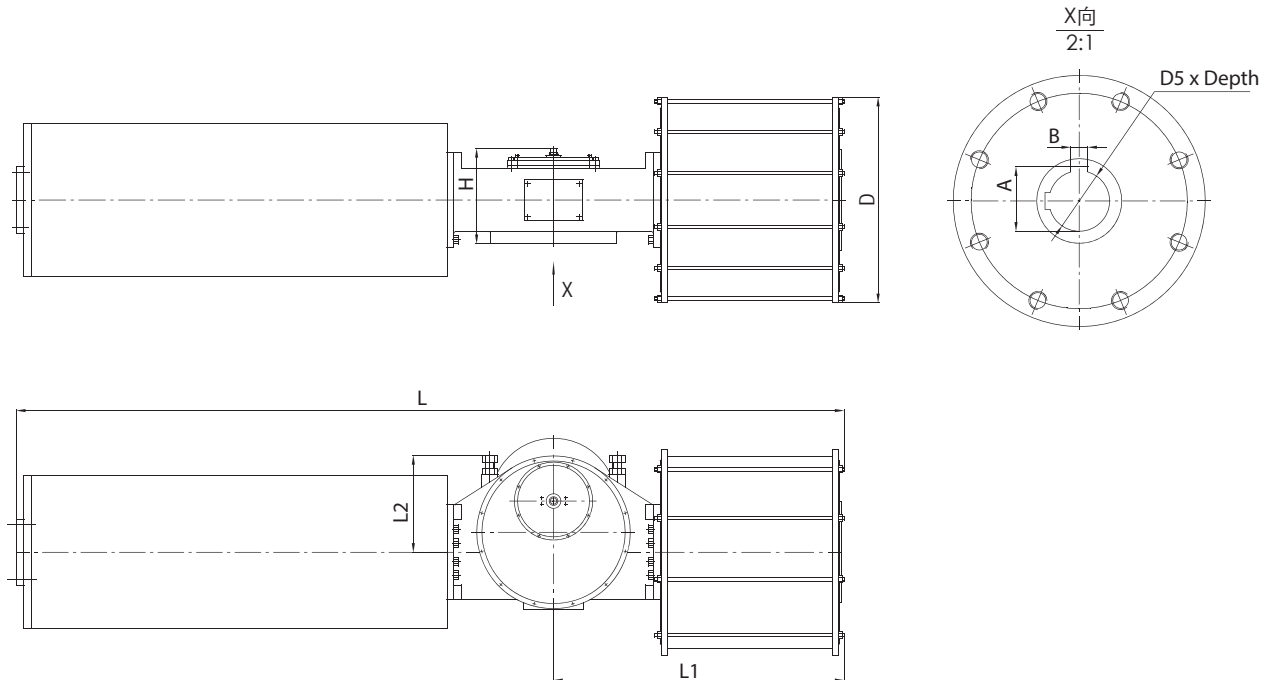

Model 型号	L	L1	L2	H	D	D5×Depth	A	B	Connecting Flange 连接法兰	Air Connection 气源接口
	mm									ISO5211
HY-C06-201-SRC4	1323	505	180	212	□225	Ø48x65	51.8	14	F14	3/8"G(NPT)
HY-C06-201-SRC5	1343	505	180	212	□225	Ø48x65	51.8	14	F14	3/8"G(NPT)
HY-C06-201-SRC6	1383	505	180	212	□225	Ø48x65	51.8	14	F14	3/8"G(NPT)
HY-C06-221-SRC4	1343	515	180	212	□250	Ø48x65	51.8	14	F14	1/2"G(NPT)
HY-C06-221-SRC5	1383	515	180	212	□250	Ø48x65	51.8	14	F14	1/2"G(NPT)
HY-C06-221-SRC6	1423	515	180	212	□250	Ø48x65	51.8	14	F14	1/2"G(NPT)
HY-C08-221-SRC4	1487	605	200	238	□250	Ø60x100	64.4	18	F16	1/2"G(NPT)
HY-C08-221-SRC5	1507	605	200	238	□250	Ø60x100	64.4	18	F16	1/2"G(NPT)
HY-C08-221-SRC6	1527	605	200	238	□250	Ø60x100	64.4	18	F16	1/2"G(NPT)
HY-C08-251-SRC4	1507	605	200	238	□280	Ø60x100	64.4	18	F16	1/2"G(NPT)
HY-C08-251-SRC5	1527	605	200	238	□280	Ø60x100	64.4	18	F16	1/2"G(NPT)
HY-C08-251-SRC6	1567	605	200	238	□280	Ø60x100	64.4	18	F16	1/2"G(NPT)
HY-C08-281-SRC4	1527	605	200	238	□310	Ø60x100	64.4	18	F16	1/2"G(NPT)
HY-C08-281-SRC5	1567	605	200	238	□310	Ø60x100	64.4	18	F16	1/2"G(NPT)
HY-C08-281-SRC6	1597	605	200	238	□310	Ø60x100	64.4	18	F16	1/2"G(NPT)
HY-C1-281-SRC4	1740	680	225	246	□310	Ø72x120	76.9	20	F25/F16	1/2"G(NPT)
HY-C1-281-SRC5	1720	680	225	246	□310	Ø72x120	76.9	20	F25/F16	1/2"G(NPT)
HY-C1-281-SRC6	1720	680	225	246	□310	Ø72x120	76.9	20	F25/F16	1/2"G(NPT)
HY-C1-321-SRC4	1700	660	225	246	Ø395	Ø72x120	76.9	20	F25/F16	1/2"G(NPT)
HY-C1-321-SRC5	1700	660	225	246	Ø395	Ø72x120	76.9	20	F25/F16	1/2"G(NPT)
HY-C1-321-SRC6	1720	660	225	246	Ø395	Ø72x120	76.9	20	F25/F16	1/2"G(NPT)
HY-C1-351-SRC4	1700	660	225	246	Ø430	Ø72x120	76.9	20	F25/F16	3/4"G(NPT)
HY-C1-351-SRC5	1720	660	225	246	Ø430	Ø72x120	76.9	20	F25/F16	3/4"G(NPT)
HY-C1-351-SRC6	1800	660	225	246	Ø430	Ø72x120	76.9	20	F25/F16	3/4"G(NPT)

Model 型号	L	L1	L2	H	D	D5xDepth	A	B	Connecting Flange 连接法兰	Air Connection 气源接口
	mm								ISO5211	
HY-C1-401-SRC4	1720	660	225	246	Ø500	Ø72x120	76.9	20	F25/F16	1"G(NPT)
HY-C1-401-SRC5	1750	660	225	246	Ø500	Ø72x120	76.9	20	F25/F16	1"G(NPT)
HY-C1-401-SRC6	1762	660	225	246	Ø500	Ø72x120	76.9	20	F25/F16	1"G(NPT)
HY-C2-401-SRC4	1961	775	285	267	Ø500	Ø100x150	106.4	28	F30/F25	1"G(NPT)
HY-C2-401-SRC5	1961	775	285	267	Ø500	Ø100x150	106.4	28	F30/F25	1"G(NPT)
HY-C2-401-SRC6	1991	775	285	267	Ø500	Ø100x150	106.4	28	F30/F25	1"G(NPT)
HY-C2-451-SRC4	1961	775	285	267	Ø550	Ø100x150	106.4	28	F30/F25	1"G(NPT)
HY-C2-451-SRC5	1991	775	285	267	Ø550	Ø100x150	106.4	28	F30/F25	1"G(NPT)
HY-C2-451-SRC6	2041	775	285	267	Ø550	Ø100x150	106.4	28	F30/F25	1"G(NPT)
HY-C3-451-SRC4	2231	915	345	310	Ø550	Ø160x200	169.4	40	F35/F30	1"G(NPT)
HY-C3-451-SRC5	2251	915	345	310	Ø550	Ø160x200	169.4	40	F35/F30	1"G(NPT)
HY-C3-451-SRC6	2351	915	345	310	Ø550	Ø160x200	169.4	40	F35/F30	1"G(NPT)
HY-C3-501-SRC4	2251	915	345	310	Ø600	Ø160x200	169.4	40	F35/F30	1 1/4"G(NPT)
HY-C3-501-SRC5	2351	915	345	310	Ø600	Ø160x200	169.4	40	F35/F30	1 1/4"G(NPT)
HY-C3-501-SRC6	2401	915	345	310	Ø600	Ø160x200	169.4	40	F35/F30	1 1/4"G(NPT)
HY-C3-561-SRC4	2351	915	345	310	Ø660	Ø160x200	169.4	40	F35/F30	1 1/4"G(NPT)
HY-C3-561-SRC5	2401	915	345	310	Ø660	Ø160x200	169.4	40	F35/F30	1 1/4"G(NPT)
HY-C3-561-SRC6	2451	915	345	310	Ø660	Ø160x200	169.4	40	F35/F30	1 1/4"G(NPT)
HY-C3-631-SRC4	2401	915	345	310	Ø730	Ø160x200	169.4	40	F35/F30	1 1/2"G(NPT)
HY-C3-631-SRC5	2511	915	345	310	Ø730	Ø160x200	169.4	40	F35/F30	1 1/2"G(NPT)
HY-C3-631-SRC6	2591	915	345	310	Ø730	Ø160x200	169.4	40	F35/F30	1 1/2"G(NPT)
HY-C4-631-SRC4	2751	1050	412	340	Ø730	Ø180x220	190.4	45	F40	1 1/2"G(NPT)
HY-C4-631-SRC5	2831	1050	412	340	Ø730	Ø180x220	190.4	45	F40	1 1/2"G(NPT)
HY-C4-631-SRC6	2911	1050	412	340	Ø730	Ø180x220	190.4	45	F40	1 1/2"G(NPT)
HY-C4-701-SRC4	2831	1050	412	340	Ø810	Ø180x220	190.4	45	F40	1 1/2"G(NPT)
HY-C4-701-SRC5	2911	1050	412	340	Ø810	Ø180x220	190.4	45	F40	1 1/2"G(NPT)
HY-C4-701-SRC6	2951	1050	412	340	Ø810	Ø180x220	190.4	45	F40	1 1/2"G(NPT)
HY-C4-801-SRC4	2911	1050	412	340	Ø910	Ø180x220	190.4	45	F40	1 1/2"G(NPT)
HY-C4-801-SRC5	2951	1050	412	340	Ø910	Ø180x220	190.4	45	F40	1 1/2"G(NPT)
HY-C4-801-SRC6	3121	1050	412	340	Ø910	Ø180x220	190.4	45	F40	1 1/2"G(NPT)
HY-C5-801-SRC4	3273	1230	486	420	Ø910	Ø220x250	231.4	50	F48/F40	1 1/2"G(NPT)
HY-C5-801-SRC5	3493	1230	486	420	Ø910	Ø220x250	231.4	50	F48/F40	1 1/2"G(NPT)
HY-C5-801-SRC6	3613	1230	486	420	Ø910	Ø220x250	231.4	50	F48/F40	1 1/2"G(NPT)
HY-C5-901-SRC4	3493	1230	486	420	Ø1010	Ø220x250	231.4	50	F48/F40	2"G(NPT)
HY-C5-901-SRC5	3613	1230	486	420	Ø1010	Ø220x250	231.4	50	F48/F40	2"G(NPT)
HY-C5-901-SRC6	3773	1230	486	420	Ø1010	Ø220x250	231.4	50	F48/F40	2"G(NPT)
HY-C6-801-SRC4	4050	1555	658	490	Ø910	Ø280x320	292.4	63	F60/F48	1 1/2"G(NPT)
HY-C6-801-SRC5	4310	1555	658	490	Ø910	Ø280x320	292.4	63	F60/F48	1 1/2"G(NPT)
HY-C6-801-SRC6	4320	1555	658	490	Ø910	Ø280x320	292.4	63	F60/F48	1 1/2"G(NPT)
HY-C6-901-SRC4	4310	1555	658	490	Ø1010	Ø280x320	292.4	63	F60/F48	2"G(NPT)
HY-C6-901-SRC5	4320	1555	658	490	Ø1010	Ø280x320	292.4	63	F60/F48	2"G(NPT)
HY-C6-901-SRC6	4430	1555	658	490	Ø1010	Ø280x320	292.4	63	F60/F48	2"G(NPT)
HY-C6-1001-SRC4	4320	1555	658	490	Ø1110	Ø280x320	292.4	63	F60/F48	2"G(NPT)
HY-C6-1001-SRC5	4430	1555	658	490	Ø1110	Ø280x320	292.4	63	F60/F48	2"G(NPT)
HY-C6-1001-SRC6	4600	1555	658	490	Ø1110	Ø280x320	292.4	63	F60/F48	2"G(NPT)

The dimension of D5 can be customized according to your requirements.  
轴孔D5可以根据阀杆尺寸定制。

## Dimension of HY-C (FO)Series Spring Return Actuator

### HY-C (FO)单作用执行器外形尺寸

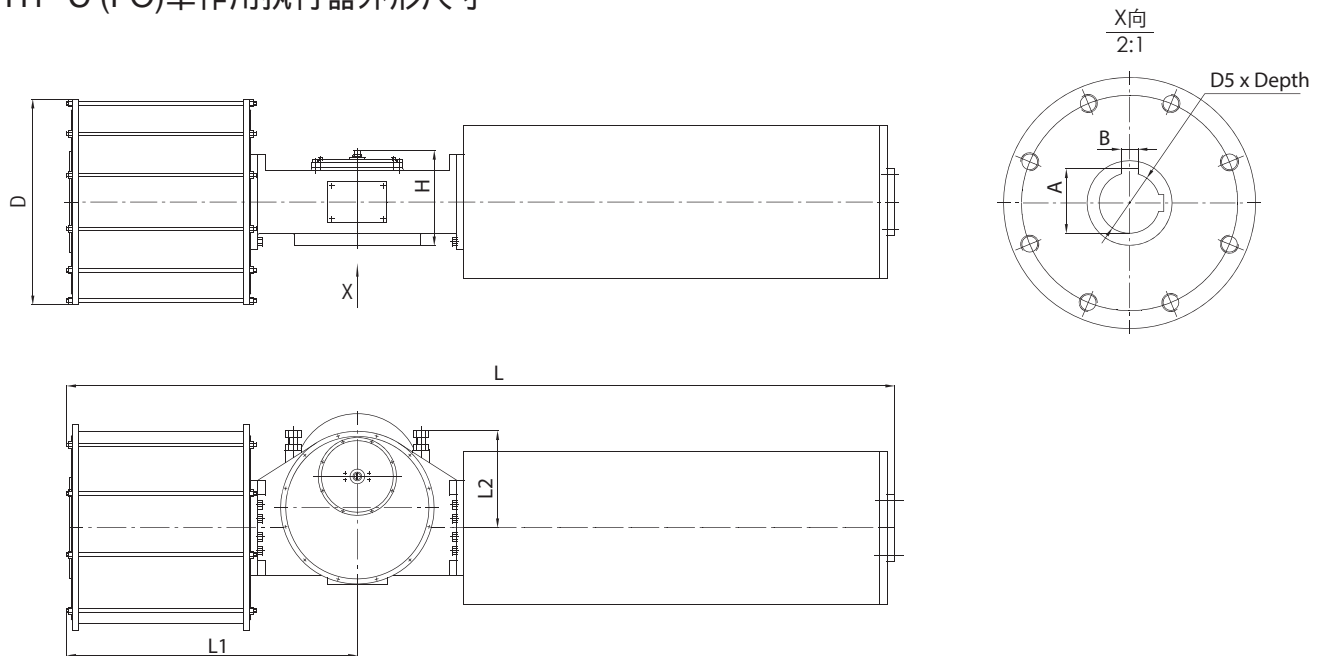

Model 型号	L	L1	L2	H	D	D5xDepth	A	B	Connecting Flange 连接法兰	Air Connection 气源接口
	mm									ISO5211
HY-C06-201-SRO4	1348	505	180	212	□225	Ø48x65	51.8	14	F14	3/8"G(NPT)
HY-C06-201-SRO5	1298	505	180	212	□225	Ø48x65	51.8	14	F14	3/8"G(NPT)
HY-C06-201-SRO6	1328	505	180	212	□225	Ø48x65	51.8	14	F14	3/8"G(NPT)
HY-C06-221-SRO4	1298	515	180	212	□250	Ø48x65	51.8	14	F14	1/2"G(NPT)
HY-C06-221-SRO5	1328	515	180	212	□250	Ø48x65	51.8	14	F14	1/2"G(NPT)
HY-C06-221-SRO6	1348	515	180	212	□250	Ø48x65	51.8	14	F14	1/2"G(NPT)
HY-C08-221-SRO4	1487	605	200	238	□250	Ø60x100	64.4	18	F16	1/2"G(NPT)
HY-C08-221-SRO5	1487	605	200	238	□250	Ø60x100	64.4	18	F16	1/2"G(NPT)
HY-C08-221-SRO6	1487	605	200	238	□250	Ø60x100	64.4	18	F16	1/2"G(NPT)
HY-C08-251-SRO4	1487	605	200	238	□280	Ø60x100	64.4	18	F16	1/2"G(NPT)
HY-C08-251-SRO5	1487	605	200	237	□280	Ø60x100	64.4	18	F16	1/2"G(NPT)
HY-C08-251-SRO6	1507	605	200	237	□280	Ø60x100	64.4	18	F16	1/2"G(NPT)
HY-C08-281-SRO4	1487	605	200	237	□310	Ø60x100	64.4	18	F16	1/2"G(NPT)
HY-C08-281-SRO5	1507	605	200	237	□310	Ø60x100	64.4	18	F16	1/2"G(NPT)
HY-C08-281-SRO6	1537	605	200	237	□310	Ø60x100	64.4	18	F16	1/2"G(NPT)
HY-C1-281-SRO4	1680	680	225	246	□310	Ø72x120	76.9	20	F25/F16	1/2"G(NPT)
HY-C1-281-SRO5	1680	680	225	246	□310	Ø72x120	76.9	20	F25/F16	1/2"G(NPT)
HY-C1-281-SRO6	1680	680	225	246	□310	Ø72x120	76.9	20	F25/F16	1/2"G(NPT)
HY-C1-321-SRO4	1660	660	225	246	Ø395	Ø72x120	76.9	20	F25/F16	1/2"G(NPT)
HY-C1-321-SRO5	1660	660	225	246	Ø395	Ø72x120	76.9	20	F25/F16	1/2"G(NPT)
HY-C1-321-SRO6	1710	660	225	246	Ø395	Ø72x120	76.9	20	F25/F16	1/2"G(NPT)
HY-C1-351-SRO4	1660	660	225	246	Ø430	Ø72x120	76.9	20	F25/F16	3/4"G(NPT)
HY-C1-351-SRO5	1710	660	225	246	Ø430	Ø72x120	76.9	20	F25/F16	3/4"G(NPT)
HY-C1-351-SRO6	1710	660	225	246	Ø430	Ø72x120	76.9	20	F25/F16	3/4"G(NPT)

Model 型号	L	L1	L2	H	D	D5×Depth	A	B	Connecting Flange 连接法兰	Air Connection 气源接口
	mm								ISO5211	
HY-C1-401-SRO4	1710	660	225	246	Ø500	Ø72x120	76.9	20	F25/F16	1"G(NPT)
HY-C1-401-SRO5	1710	660	225	246	Ø500	Ø72x120	76.9	20	F25/F16	1"G(NPT)
HY-C1-401-SRO6	1730	660	225	246	Ø500	Ø72x120	76.9	20	F25/F16	1"G(NPT)
HY-C2-401-SRO4	1898	775	285	269	Ø500	Ø100x150	106.4	28	F30/F25	1"G(NPT)
HY-C2-401-SRO5	1928	775	285	269	Ø500	Ø100x150	106.4	28	F30/F25	1"G(NPT)
HY-C2-401-SRO6	1948	775	285	269	Ø500	Ø100x150	106.4	28	F30/F25	1"G(NPT)
HY-C2-451-SRO4	1928	775	285	269	Ø550	Ø100x150	106.4	28	F30/F25	1"G(NPT)
HY-C2-451-SRO5	1948	775	285	269	Ø550	Ø100x150	106.4	28	F30/F25	1"G(NPT)
HY-C2-451-SRO6	1948	775	285	269	Ø550	Ø100x150	106.4	28	F30/F25	1"G(NPT)
HY-C3-451-SRO4	2143	915	345	310	Ø550	Ø160x200	169.4	40	F35/F30	1"G(NPT)
HY-C3-451-SRO5	2193	915	345	310	Ø550	Ø160x200	169.4	40	F35/F30	1"G(NPT)
HY-C3-451-SRO6	2193	915	345	310	Ø550	Ø160x200	169.4	40	F35/F30	1"G(NPT)
HY-C3-501-SRO4	2193	915	345	310	Ø600	Ø160x200	169.4	40	F35/F30	1 1/4"G(NPT)
HY-C3-501-SRO5	2193	915	345	310	Ø600	Ø160x200	169.4	40	F35/F30	1 1/4"G(NPT)
HY-C3-501-SRO6	2243	915	345	310	Ø600	Ø160x200	169.4	40	F35/F30	1 1/4"G(NPT)
HY-C3-561-SRO4	2193	915	345	310	Ø660	Ø160x200	169.4	40	F35/F30	1 1/4"G(NPT)
HY-C3-561-SRO5	2243	915	345	310	Ø660	Ø160x200	169.4	40	F35/F30	1 1/4"G(NPT)
HY-C3-561-SRO6	2273	915	345	310	Ø660	Ø160x200	169.4	40	F35/F30	1 1/4"G(NPT)
HY-C3-631-SRO4	2273	915	345	310	Ø730	Ø160x200	169.4	40	F35/F30	1 1/2"G(NPT)
HY-C3-631-SRO5	2323	915	345	310	Ø730	Ø160x200	169.4	40	F35/F30	1 1/2"G(NPT)
HY-C3-631-SRO6	2373	915	345	310	Ø730	Ø160x200	169.4	40	F35/F30	1 1/2"G(NPT)
HY-C4-631-SRO4	2667	1050	412	340	Ø730	Ø180x220	190.4	45	F40	1 1/2"G(NPT)
HY-C4-631-SRO5	2693	1050	412	340	Ø730	Ø180x220	190.4	45	F40	1 1/2"G(NPT)
HY-C4-631-SRO6	2763	1050	412	340	Ø730	Ø180x220	190.4	45	F40	1 1/2"G(NPT)
HY-C4-701-SRO4	2693	1050	412	340	Ø810	Ø180x220	190.4	45	F40	1 1/2"G(NPT)
HY-C4-701-SRO5	2763	1050	412	340	Ø810	Ø180x220	190.4	45	F40	1 1/2"G(NPT)
HY-C4-701-SRO6	2843	1050	412	340	Ø810	Ø180x220	190.4	45	F40	1 1/2"G(NPT)
HY-C4-801-SRO4	2763	1050	412	340	Ø910	Ø180x220	190.4	45	F40	1 1/2"G(NPT)
HY-C4-801-SRO5	2843	1050	412	340	Ø910	Ø180x220	190.4	45	F40	1 1/2"G(NPT)
HY-C4-801-SRO6	2973	1050	412	340	Ø910	Ø180x220	190.4	45	F40	1 1/2"G(NPT)
HY-C5-801-SRO4	3176	1230	486	420	Ø910	Ø220x250	231.4	50	F48/F40	1 1/2"G(NPT)
HY-C5-801-SRO5	3236	1230	486	420	Ø910	Ø220x250	231.4	50	F48/F40	1 1/2"G(NPT)
HY-C5-801-SRO6	3296	1230	486	420	Ø910	Ø220x250	231.4	50	F48/F40	1 1/2"G(NPT)
HY-C5-901-SRO4	3236	1230	486	420	Ø1010	Ø220x250	231.4	50	F48/F40	2"G(NPT)
HY-C5-901-SRO5	3296	1230	486	420	Ø1010	Ø220x250	231.4	50	F48/F40	2"G(NPT)
HY-C5-901-SRO6	3386	1230	486	420	Ø1010	Ø220x250	231.4	50	F48/F40	2"G(NPT)
HY-C6-801-SRO4	4092	1555	658	490	Ø910	Ø280x320	292.4	63	F60/F48	1 1/2"G(NPT)
HY-C6-801-SRO5	4167	1555	658	490	Ø910	Ø280x320	292.4	63	F60/F48	1 1/2"G(NPT)
HY-C6-801-SRO6	4177	1555	658	490	Ø910	Ø280x320	292.4	63	F60/F48	1 1/2"G(NPT)
HY-C6-901-SRO4	4167	1555	658	490	Ø1010	Ø280x320	292.4	63	F60/F48	2"G(NPT)
HY-C6-901-SRO5	4177	1555	658	490	Ø1010	Ø280x320	292.4	63	F60/F48	2"G(NPT)
HY-C6-901-SRO6	4087	1555	658	490	Ø1010	Ø280x320	292.4	63	F60/F48	2"G(NPT)
HY-C6-1001-SRO4	4177	1555	658	490	Ø1110	Ø280x320	292.4	63	F60/F48	2"G(NPT)
HY-C6-1001-SRO5	4087	1555	658	490	Ø1110	Ø280x320	292.4	63	F60/F48	2"G(NPT)
HY-C6-1001-SRO6	4247	1555	658	490	Ø1110	Ø280x320	292.4	63	F60/F48	2"G(NPT)

The dimension of D5 can be customized according to your requirements.  
轴孔D5可以根据阀杆尺寸定制。

## Modular Design

### 模块化设计

The HY Series adds an extra measure of versatility with its field serviceable modular configuration. It can be altered from a single acting to a double-acting and add a hydraulic manual override after installation. Both the module and spring modules are removable without the need for special tools or disassembly of any modules.

HY执行器采用最新模块化的设计。可以在不需要专用工具的情况下轻松实现单作用，双作用，手动操作等模块的组合和更换。

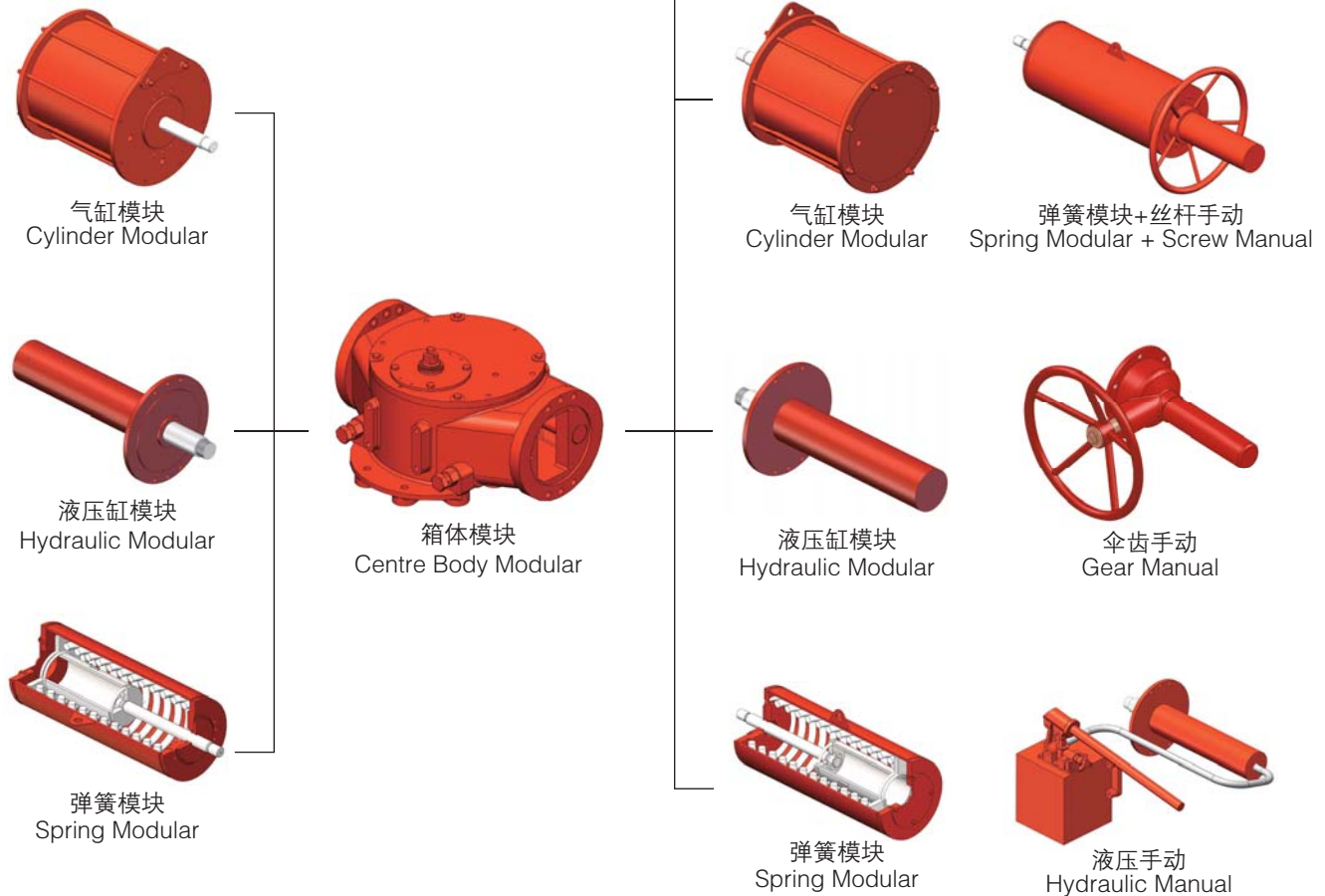

## Body Connecting Dimension

### 箱体连接尺寸

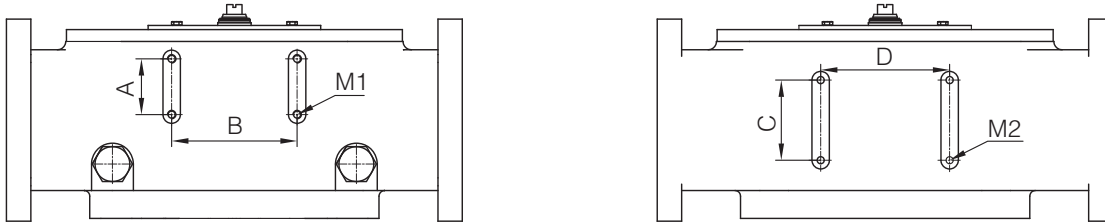

箱体号 Body No.	AxB	CxD	螺纹孔 M1 Screwed Hole	螺纹孔 M2 Screwed Hole
B06/C06	50x90	80x125	4-M12 deep 18	4-M12 deep 18
B08/C08	50x125	80x125	4-M12 deep 18	4-M12 deep 18
B1/C1	50x125	80x125	4-M12 deep 18	4-M12 deep 18
B2/C2	80x125	95x155	4-M12 deep 18	4-M12 deep 18
B3/C3	80x180	115x185	4-M12 deep 18	4-M12 deep 18
B4/C4	80x220	115x230	4-M12 deep 18	4-M12 deep 18
B5/C5	80x220	140x310	4-M12 deep 18	4-M12 deep 18
B6/C6	100x220	180x400	4-M12 deep 18	4-M12 deep 18

## How to Order 订购信息

UNIT 单元	1	2	3	4	5	6	7	8	Product code
CONTENT 内容	Series 系列	Structure 结构	Body 箱体	Cylinder 气缸	Acting Type 动作形式	Spring 弹簧规格	Manual 手动方式	Specific Requirements 特殊要求	HY-C1-501 -SRO4+HM+LT
CODE 代号	H	Y	C1	501	SR	O4	HM	LT	
EXAMPLE 示例	H	Y	C1	501	SR	O4	HM	LT	

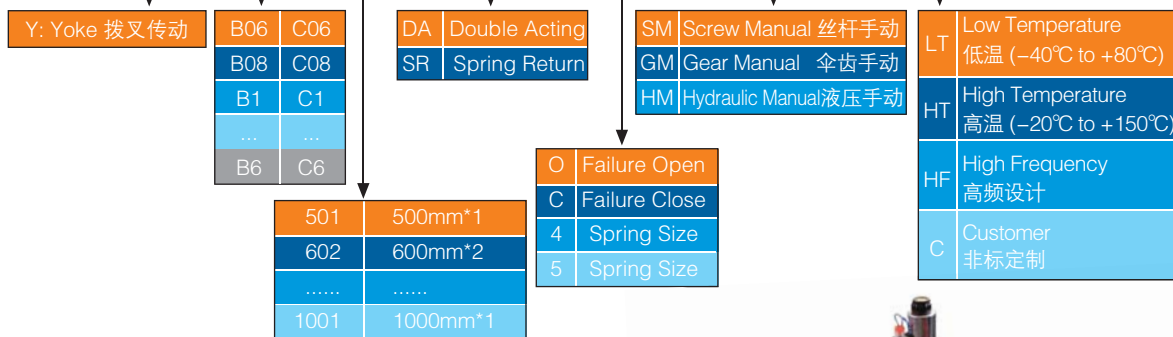



**无锡芮斯邦流体控制**  
**Wuxi Respon Flow Control**

邮编(P.C.): 214112

电话(Tel): 0086-510-85590969

传真(Fax): 0086-510-84088725

E-mail: [sales@respongroup.com](mailto:sales@respongroup.com)    [Http:// www.respongroup.com](http://www.respongroup.com)

*我公司保留对产品样本中所有数据更改的权利。  
Due to continuous development of our product range,  
we reserve the right to alter the dimensions and information contained in this catalogue as required.*